

# CITY OF WEST HOLLYWOOD

## HART PARK IMPROVEMENTS



## Public Engagement Findings Presentation

Plummer Park

02/20/2020

6 PM – 8 PM

---

# CITY OF WEST HOLLYWOOD

## HART PARK IMPROVEMENTS

---



### Meeting Agenda

- Timeline
- Scope of project
- Accessibility assessment
- Outreach summary
- Next steps

# CITY OF WEST HOLLYWOOD

## HART PARK IMPROVEMENTS



### Timeline

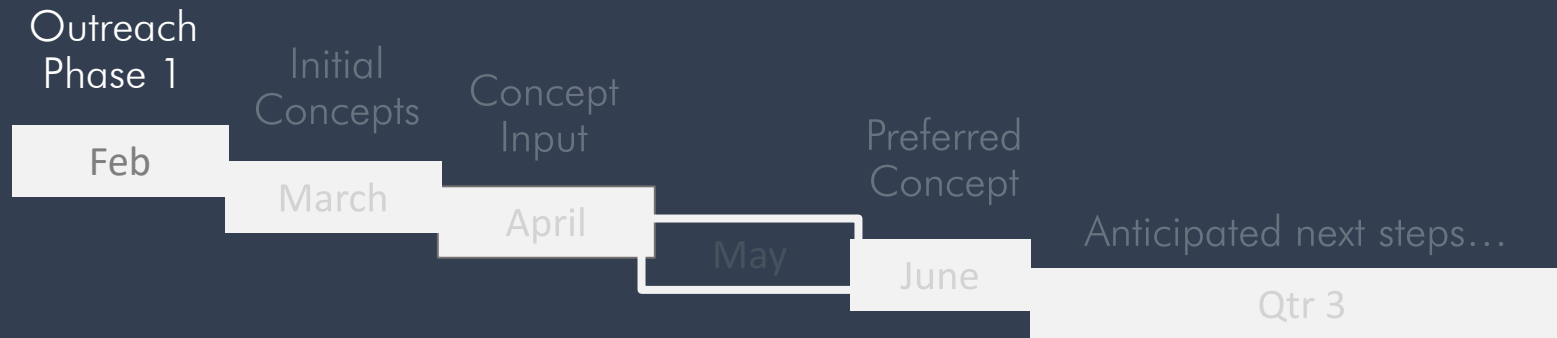

2020

# CITY OF WEST HOLLYWOOD

## HART PARK IMPROVEMENTS



### Scope of Project

- Public engagement + concepts:
  - Access improvements
  - Dog park improvements
- Buildings are *not* a part of scope



# CITY OF WEST HOLLYWOOD

## HART PARK IMPROVEMENTS



## Accessibility Assessment

- 2017 Certified Access Specialist (CASP) report

West Hollywood  
Hart Dog Park

### Park-wide

**1 - 1** Parking Area Category: 1

#### Provide or modify accessible spaces

Notes: Two accessible parking spaces are provided. A van accessible parking provided (1 van space min).

CBC: -

Other: ADA 208.2.4, 2015 CBC 11B-208.2.4

#### Install van accessible sign

Notes: A "Van Accessible" sign is not provided. Required: A "Van Accessible" posted at stalls striped and designated to be van accessible.

CBC: -

Other: ADA 208.2.4, 2015 CBC 11B-502.6

#### Install reserved parking sign

Notes: A tow-away warning sign is not provided at the street entry or at the access parking space. Contact information is not provided on tow-away warning sign.

CBC: -

Other: 2015 CBC 11B-502.8, 2015 CBC 11B-502.8.1, 2015 CBC 11B-502.8.2

#### Regrade accessible parking space or access aisle

Notes: Slopes of parking spaces and access aisle are 11% to 12% (2.0% max direction).

CBC: -

Other: ADA 502.4, 2015 CBC 11B-502.4

#### Provide or modify accessible access aisles

Notes: Shared access aisle does not have a blue border and diagonal striping inches maximum on center painted a color contrasting with the parking space.

CBC: -

Other: 2015 CBC 11B-502.3.3

#### Provide adequate striping

Notes: The words "No Parking" are not painted in the shared access aisle.

CBC: -

Other: 2015 CBC 11B-502.3.3

West Hollywood  
Hart Dog Park

### Park-wide

**4 - 2** Walk Category: 2

#### Regrade surface

Notes: Cross slope of concrete paving is 5.5% to 6.0% (2.0% max) for 13 linear feet.

CBC: -

Other: ADA 403.3, 2015 CBC 11B-403.3

**4 - 3** Walk Category: 2

#### Regrade surface

Notes: Running slope of concrete paving is 5.4% to 6.0% for approximately 15 linear feet (5.0% max).

CBC: -

Other: ADA 403.3, 2015 CBC 11B-403.3

**4 - 4** Walk Category: 2

#### Regrade surface

Notes: Running slope of concrete paving is 5.0% to 8.5% for 15 linear feet (5.0% max).

CBC: -

Other: ADA 403.3, 2015 CBC 11B-403.3

**4 - 5** Walk Category: 2

#### Regrade surface

Notes: Running slope of concrete paving is 7.2% to 8.8% for approximately 10 linear feet (5.0% max).

CBC: -

Other: ADA 403.3, 2015 CBC 11B-403.3

**4 - 6** Walk Category: 2

#### Regrade surface

Notes: Running slope of concrete paving is 5.2% to 7.0% for 10 linear feet (5.0% max).

# CITY OF WEST HOLLYWOOD

## HART PARK IMPROVEMENTS



### Accessibility Assessment

### HART PARK

**WILLIAM S. HART DOG PARK**  
 8341 DE LONGPRE AVE  
 WEST HOLLYWOOD, CA  
 PARK



#### ACCESS BARRIER KEY

- 1-# Parking Area
- 4-# Walk
- 5-# Ramp
- 6-# Stair
- 8-# Door/Gate
- 9-# Sign
- 10-# Drinking Fountain
- 19-# Multiple User Restroom
- 33-# Outdoor Constructed Features

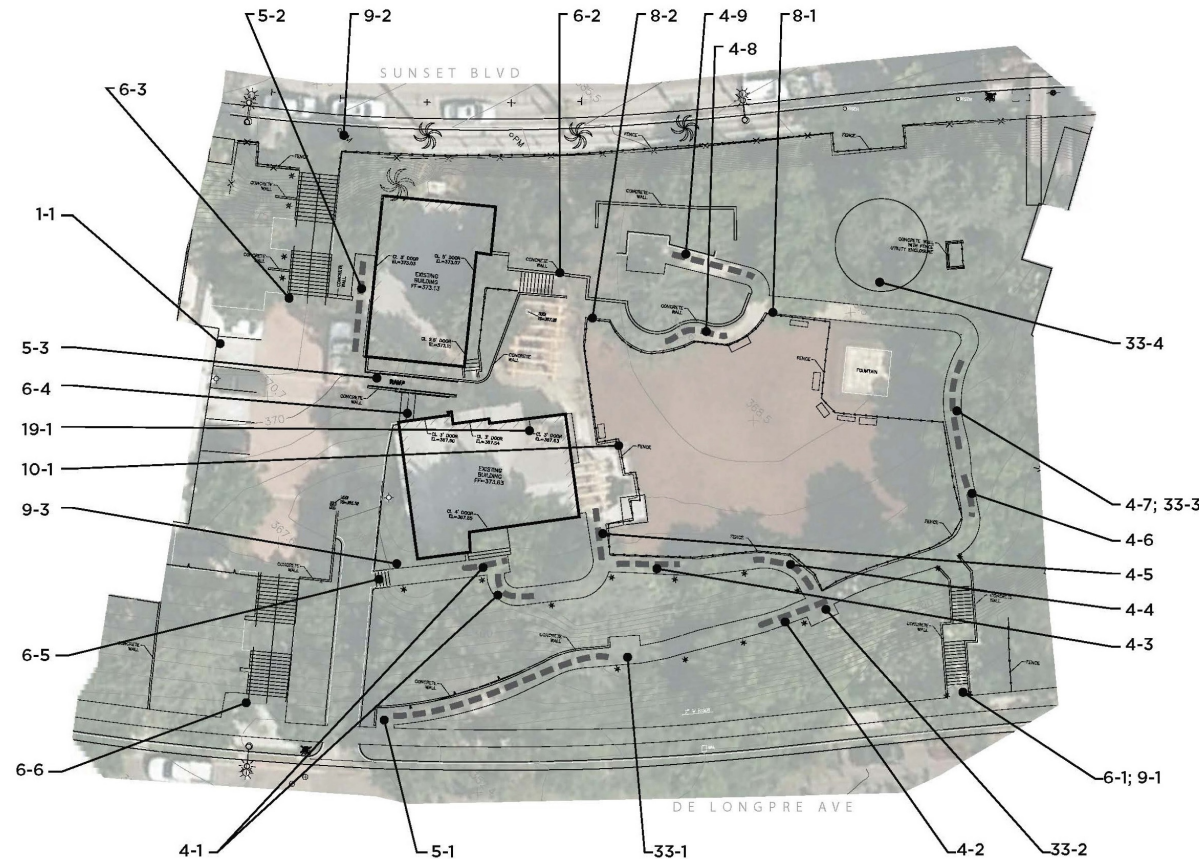

# CITY OF WEST HOLLYWOOD

## HART PARK IMPROVEMENTS



## Outreach summary

- Pop-Up #1  
Hart Park  
Sat, Feb 1, 2020



- Pop-Up #2  
WeHo Park  
Wed, Feb 5, 2020



- Pop-Up #3  
Plummer Park  
(Farmers Market)  
Mon, Feb 10, 2020



# CITY OF WEST HOLLYWOOD

## HART PARK IMPROVEMENTS



### Outreach results • Park visitation + frequency

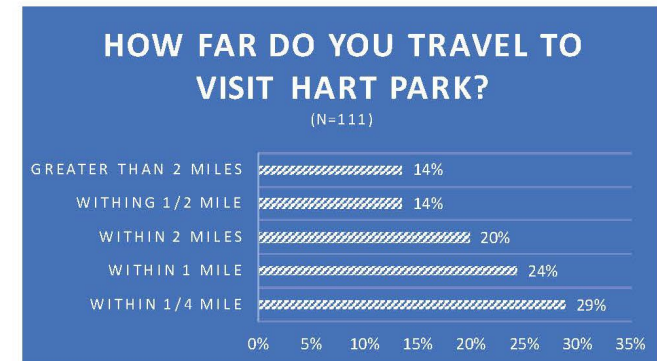
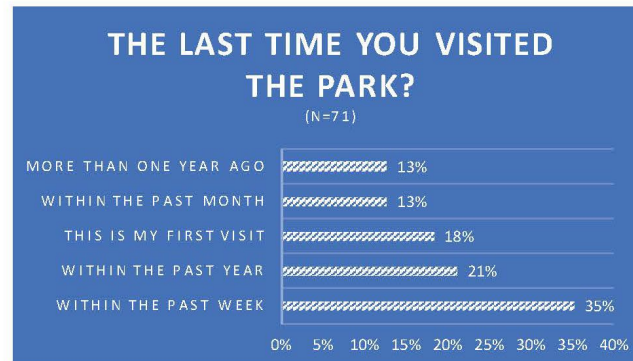
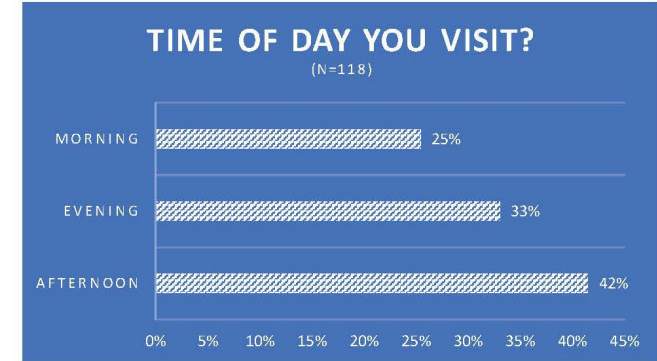
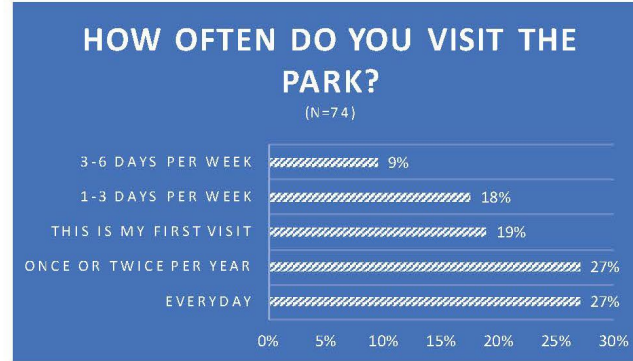
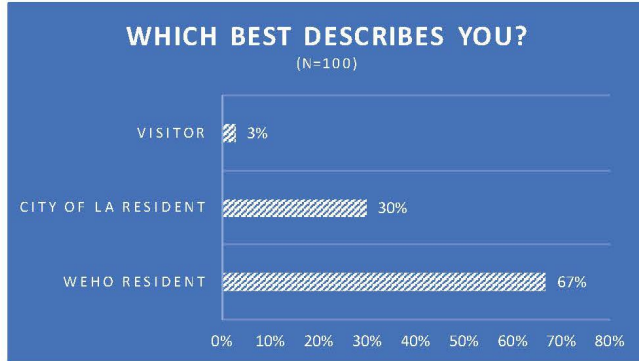

# CITY OF WEST HOLLYWOOD

## HART PARK IMPROVEMENTS



### Outreach results • Cultural relevance + Park Improvements

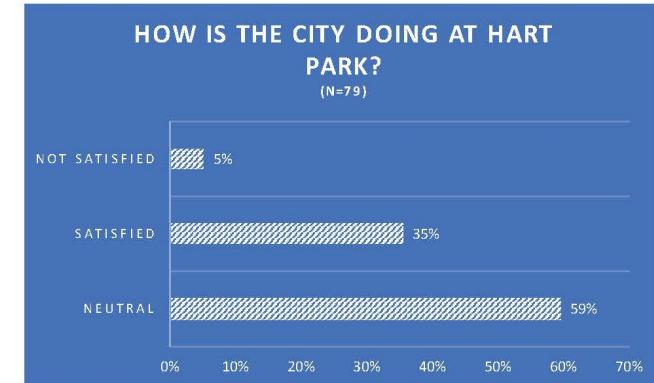
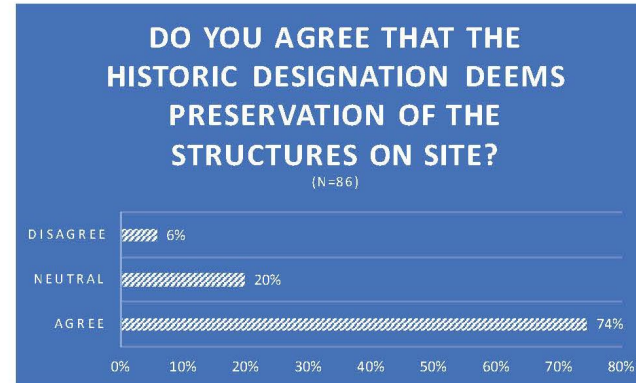

# CITY OF WEST HOLLYWOOD

## HART PARK IMPROVEMENTS



### Outreach results • Open-ended responses

#### What qualities make Hart Park successful?

- Community
- Peaceful
- Peaceful/Natural
- Good size
- Contributes to continuity of historic setting and neighborhood Hart/Sunset Tower community
- Historical recreation area blended with nature and dog park
- Quiet setting and bathroom amenities
- Large dog park area
- Seating
- Restrooms
- Restrooms!
- Quiet and peaceful
- Well-cared for
- Good location
- Clean, neat, landscaping okay

**Community**  
**Peaceful**  
**Natural**  
**Historic**

#### Is there anything about Hart Park that should not be changed?

- The mulch. Please no astroturf.
- I love the wood mulch. Astroturf tends to smell/stain.
- No astroturf.
- Keep the woodchips. Add new, more often.
- Bathrooms are icky.
- No turf please. Keep woodchips.
- Please keep the woodchips!
- Better parking and bathrooms.
- Keep chips.
- NO astroturf-smells!
- Please keep the mixed size play area. Good for socialization.
- No astroturf! Organic material perhaps smaller than bark. Aroma never leaves astroturf.
- Keep cozy and intimate
- Access

#### What elements would make Hart Park more enjoyable or usable?

- Wood chips are very hard on dog paws
- Benches south/east area
- Working water fountains for patrons
- Sun shades
- Sustainable infrastructure
- Resurface the concrete benches
- Poop bags and garbage cans by each entrance
- Better drainage
- Water fountains for dogs
- More security - many homeless
- Security/homeless
- Needs on-site security due to homeless
- Keen maintenance - Keep it simple
- Astroturf (washable)
- Wood chips could be replenished more often
- Sun shades
- Regular maintenance
- Astroturf
- Astroturf
- More shade within the park outside the dog park
- More maintenance of the wood chips. No astroturf
- More seating. More tables. More trees. More shade.
- Astroturf instead of bark for dog park
- Larger area
- Security
- Boot brush to clean poop off shoes
- Artificial turf
- Pretty fountain with benches
- Small and large dog play area with astroturf
- Enlarge area by using south side of lot
- More lighting
- K-9 turf; no wood chips
- Accessibility
- More picnic tables
- Electric car charger at parking area
- Community gardens
- More bike racks (especially at entrances)
- Improve parking situation
- More information about Actors Studio i.e. history of
- Better signage for Actors Studio
- More public parking
- Metered parking
- Community activities

#### Additional Comments?

- Bathrooms need maintenance
- Hedge along north fence
- No more wood chips
- Clean bathrooms
- Security ambassadors should check in throughout the day
- Stairs and stadium seating along the width of De Longpre to open up access to the park
- 1 part wood chip, 1 part turf. Diversity!
- Fountain improved for birds and wildlife to utilize
- Need better maintenance and wood should be replaced more often
- Wood chips are good/maintenance not regular
- Keep chips! Astro smells
- On site security. I was assaulted by homeless on Nov 12th
- Fencing is too low! My dog jumps the fence!
- Adhere to natural environment as much as possible
- Additional police officer
- Improve access from Sunset (Blvd)
- More access along De Longpre [St.] Park should be more open to street + more inviting.
- Dog park is too big - shouldn't dominate center of park - maybe on the perimeter
- Lighting is important
- Make easy to find a non-emergency number to call
- No astroturf (hot on dog paws)
- Parking is easier (and free) in the afternoon
- Yes on grass turf (artificial)
- Keep dogs on a leash outside of dog park

1. Surfacing (wood chips(15), artificial turf(10))
2. Amenities (benches, tables, drinking fountain, shade, etc.)
3. Maintenance
4. Parking

# CITY OF WEST HOLLYWOOD

## HART PARK IMPROVEMENTS



### Outreach results • Dog park amenities

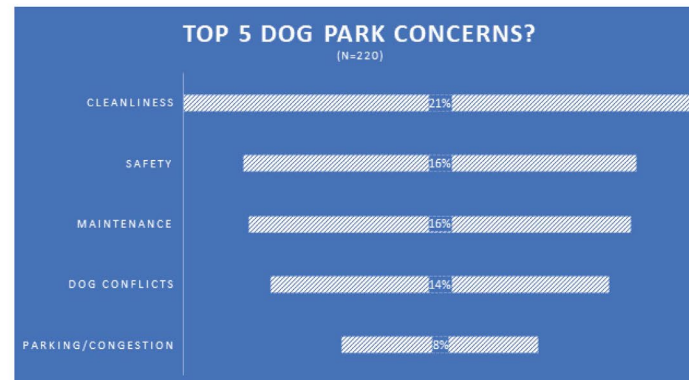
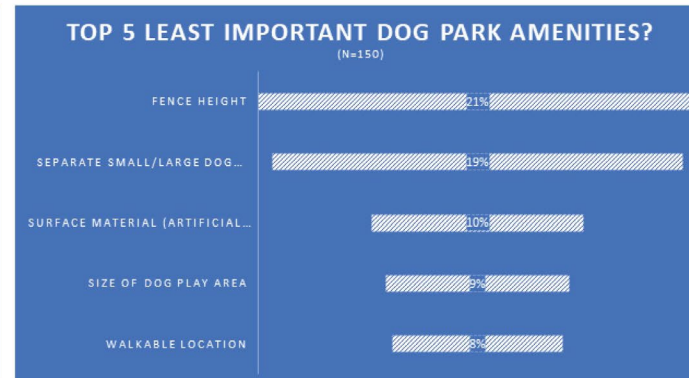

# CITY OF WEST HOLLYWOOD

## HART PARK IMPROVEMENTS



### Next steps

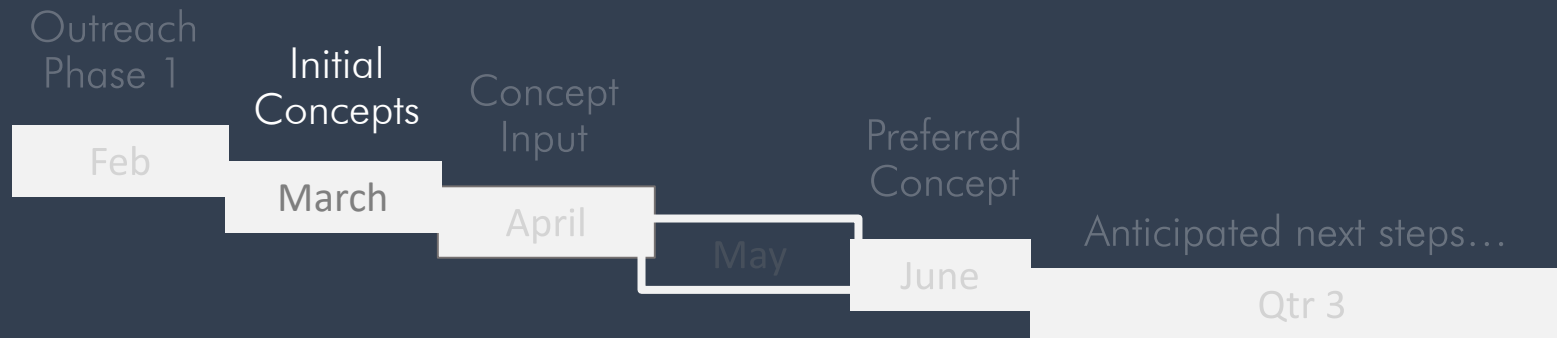

2020

# CITY OF WEST HOLLYWOOD

## HART PARK IMPROVEMENTS



## Share Your Ideas

# HART PARK.

### SCHEDULE OF EVENTS

This is a great opportunity for everyone in the community to share ideas with City staff and other community members about updating pedestrian and vehicular accessibility into the park, and to discuss possible upgrades to existing amenities offered at the park.

Thursday <b>February 20</b>	6 p.m.–8 p.m.	<b>Plummer Park</b> Rooms 5 & 6	<b>Presentation Q&amp;A Mtg #1</b> <i>Community Findings</i>
Wednesday <b>March 25</b>	6 p.m.–7:30 p.m.	<b>Plummer Park</b> Rooms 5 & 6	<b>Presentation Q&amp;A</b> <i>Visual Interpretation of Findings – 3 Concepts</i>
Wednesday <b>April 15</b>	6 p.m.–8 p.m.	<b>Plummer Park</b> Rooms 5 & 6	<b>Presentation #2</b> <i>Visual Interpretation – Preferred Concept</i>
Wednesday <b>June 10</b>	6:30 p.m.–9 p.m.	<b>City Hall EOC</b> 1st Floor	<b>Presentation #3</b> <i>Preferred Concept Approval</i>
Schedule <b>[TBD 2020]</b>	6 p.m.–9 p.m.	<b>West Hollywood Park</b> Council Chambers	<b>Presentation Final</b> <i>Final Concept Approval</i>



For updates and more information, please visit [weho.org/hartpark](http://weho.org/hartpark)



For event related special accommodations, contact Debbie Gonzalez within 48 hours prior to event date at [DeGonzalez@weho.org](mailto:DeGonzalez@weho.org) or (323) 848-3116.