

Streetscape Master Plan Working Group Meeting No. 4

THE
AVENUES

ART, FASHION & DESIGN DISTRICT
WEST HOLLYWOOD

Meeting	Topic	Date
1	Kick Off Meeting	April 3
2	Walkability & Vision	May 1
3	Mobility ped/bike/traffic flow improvements District parking & valet	June 12
4	Streetscape walkways/parkways/setbacks, street trees & lights, paving	August 14
5	Streetscape gathering places, wayfinding, furnishings, other lighting, art	September
	Community open house	September
	Draft Streetscape Master Plan review	October
	Final Streetscape Master Plan	December

Where we are in process

Presentation (45 minutes):

1. Review Working Group's mobility choices.
2. Introduce streetscape element options:
 - Sidewalk layout and treatment
 - Street trees
 - Street lights
 - Paving – crosswalks
 - Paving – sidewalks

Work Session (1 hour +) – break into groups

1. Select **preferred option(s)** for each element
2. Present back to entire group

1. **Even out traffic flow/shift some peak hour through traffic** from Collectors Melrose to Arterials.
2. **Move curbs** to a consistent roadway width.
3. **Re-balance uses** within the ROW.
4. **Enhance** pedestrian and bike **access/safety**.

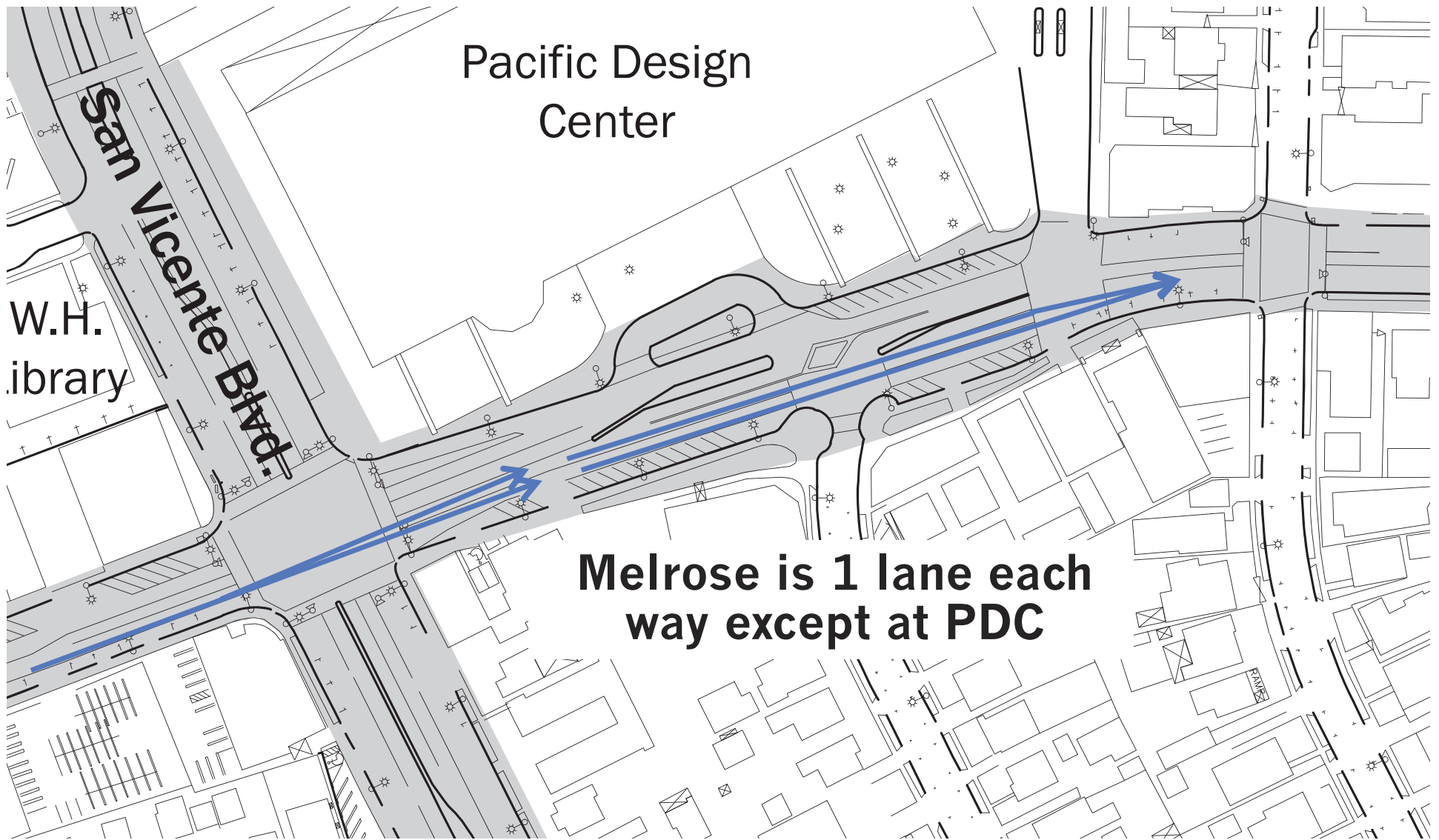

1.a. Even out traffic flow: consistent lanes

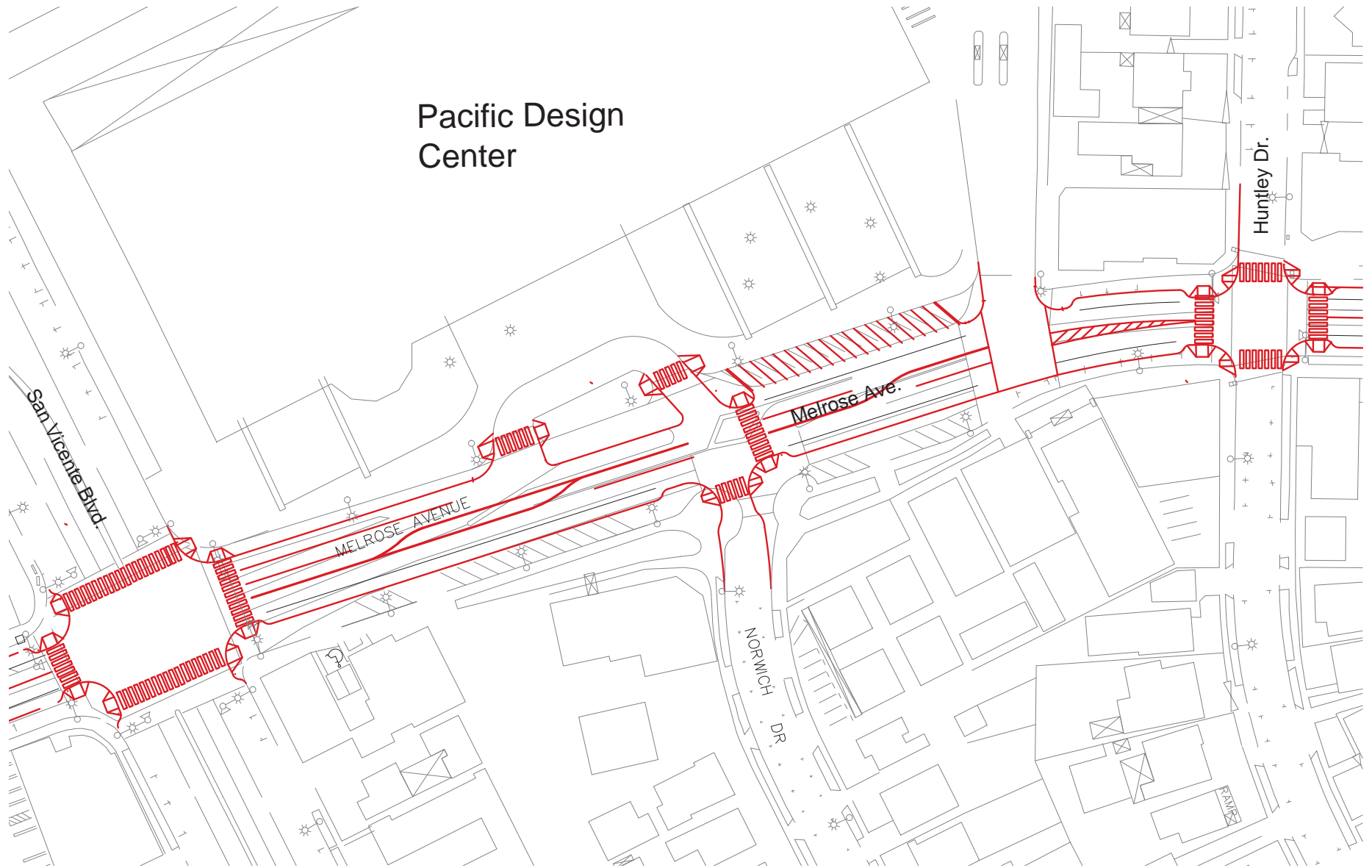

1. a. Even out traffic flow: consistent lanes

A.M. Peak Hour
Traffic Today
(1 hour bet. 7 – 9 am)

Cieneşa Blvd.

More cars than
fit in 1 lane

More cars than fit
in 1 left-turn lane

1.b. Even out traffic flow: improve merge

A.M. Peak Hour – Mostly Through Traffic

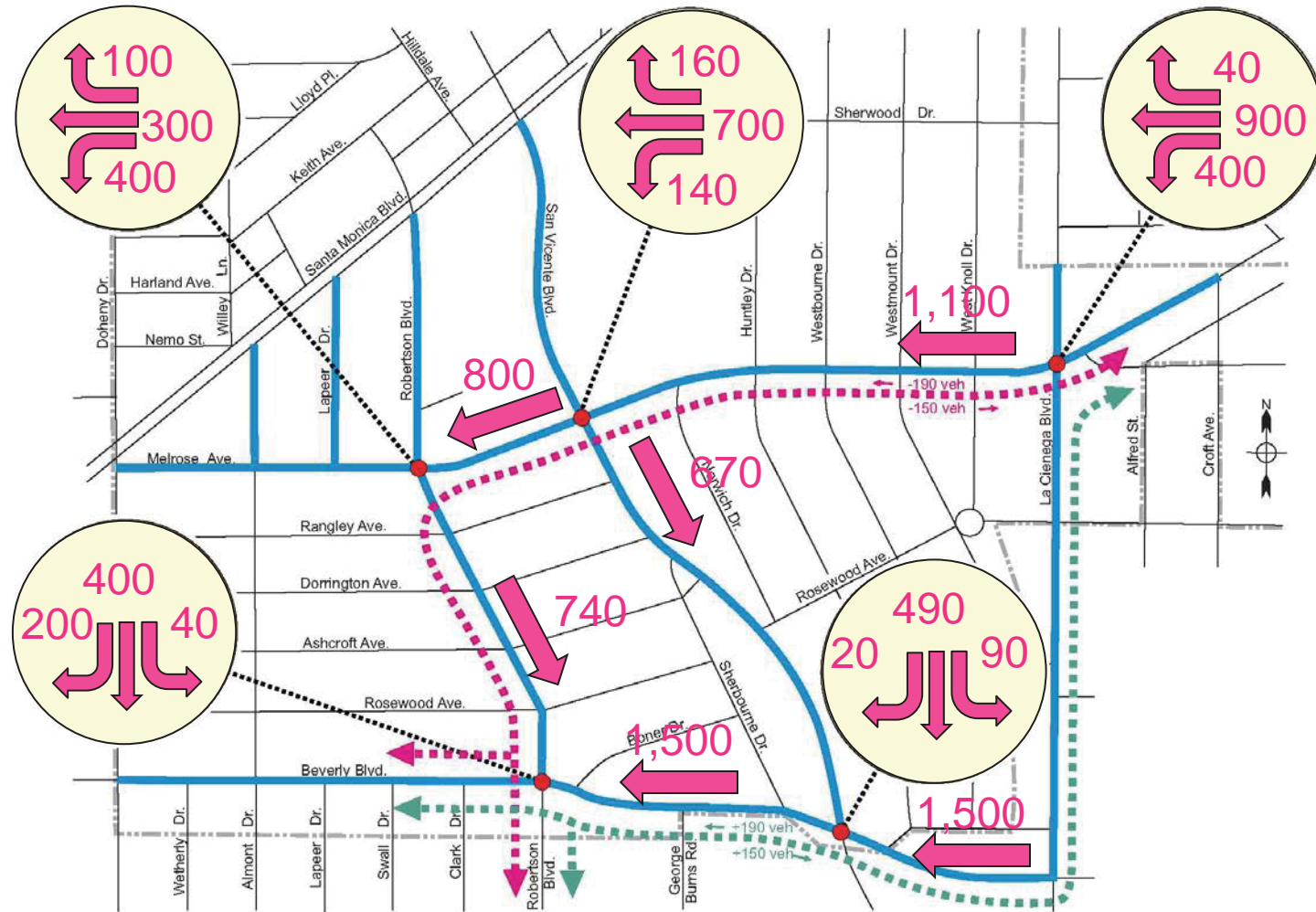

1.b. Even out traffic flow

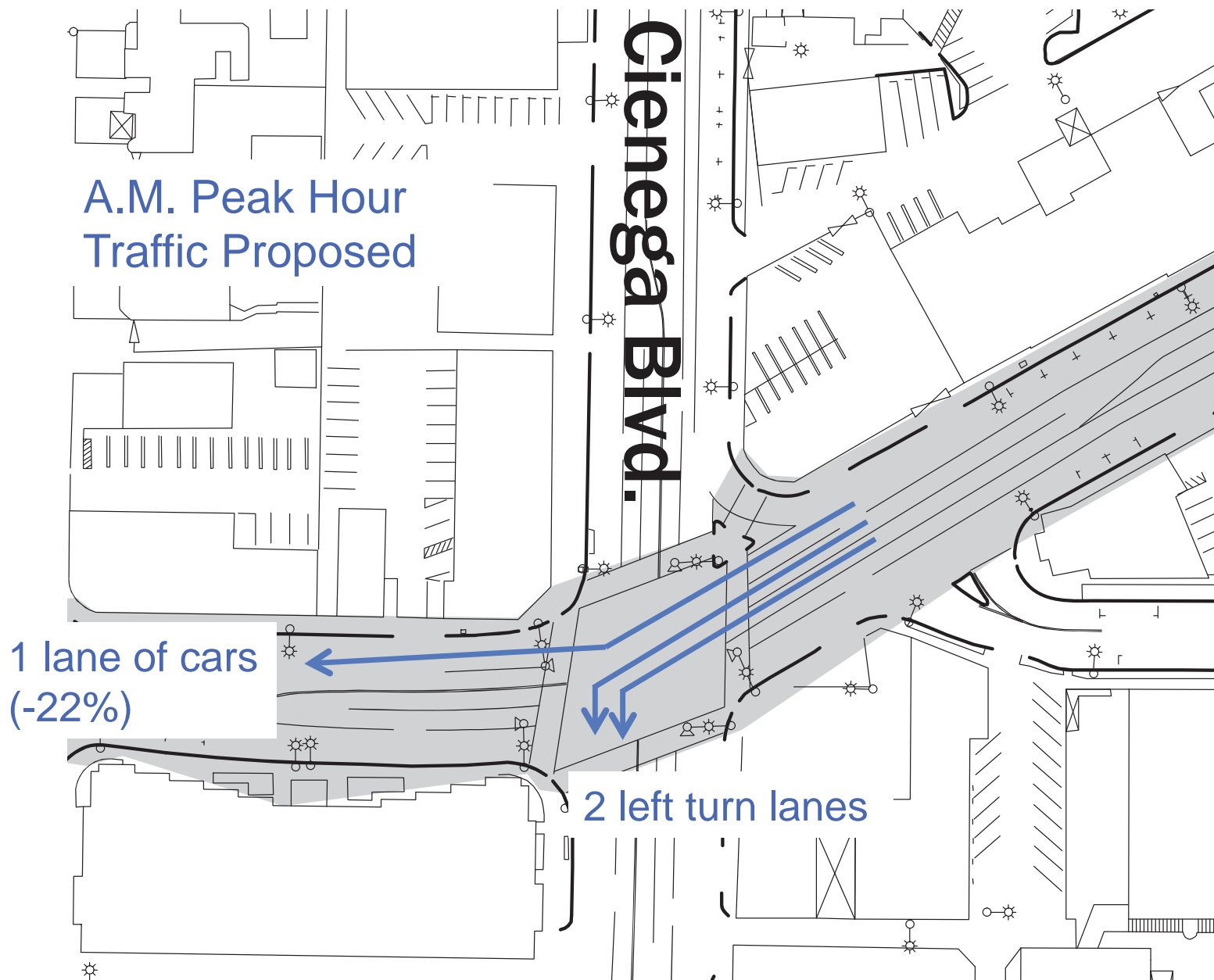

1.b. Even out traffic flow: improve merge

Center Turn Lane

- Existing to remain in all options
- X May be eliminated



2. Improved traffic flow allows us to eliminate center turn lane from Huntley – West Knoll

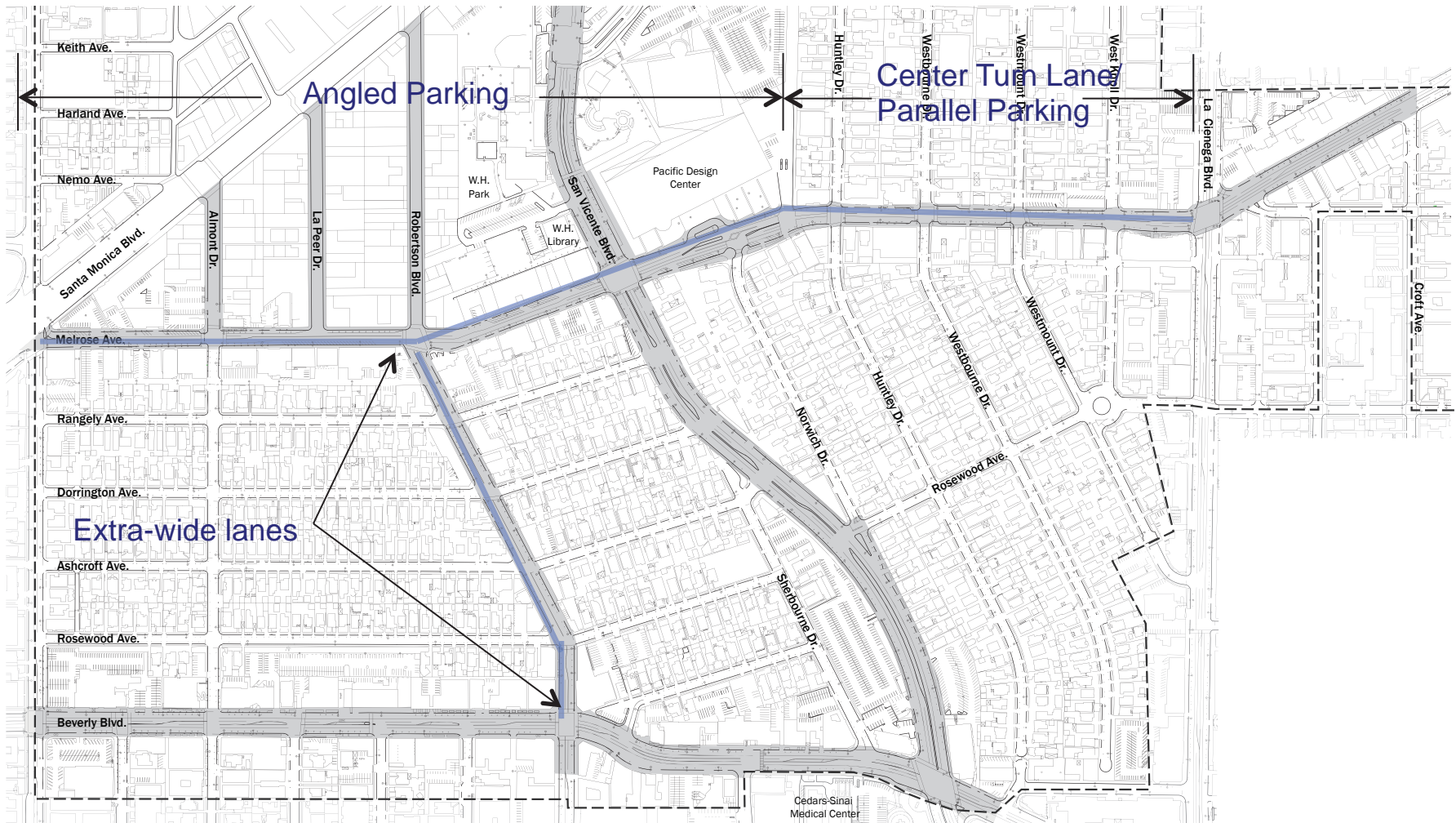

Leaving 10' on Melrose/Robertson for other modes.

SUMMARY OF OPTIONS SELECTED BY WORKING GROUP AT 6/12/12 MEETING

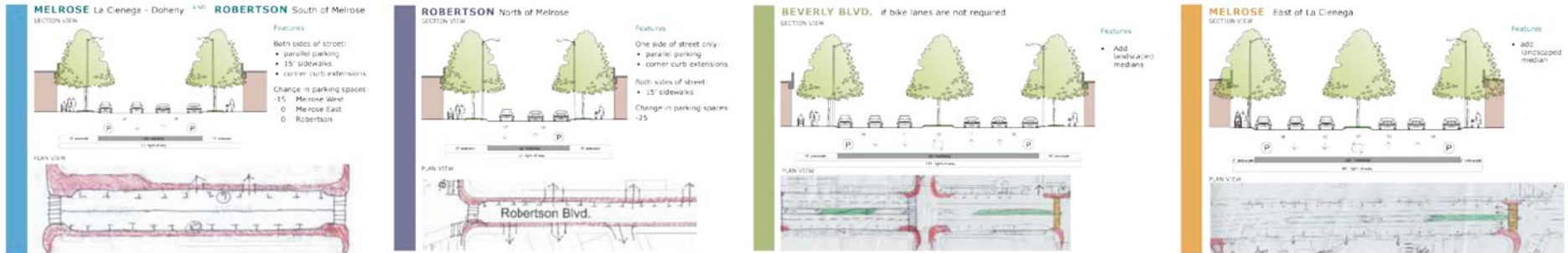

Approximate change in parking spaces relative to existing:

- Robertson north of Melrose
-25 parking spaces
- Melrose west of San Vicente
-15 parking spaces

No change elsewhere.



3. Re-balance uses in the ROW: selected options.

Selected: Existing + gateway median

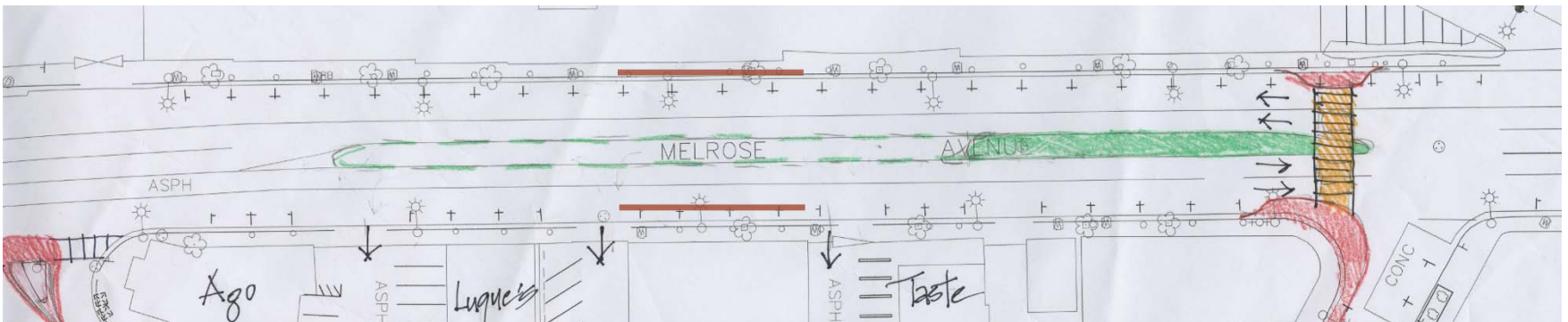
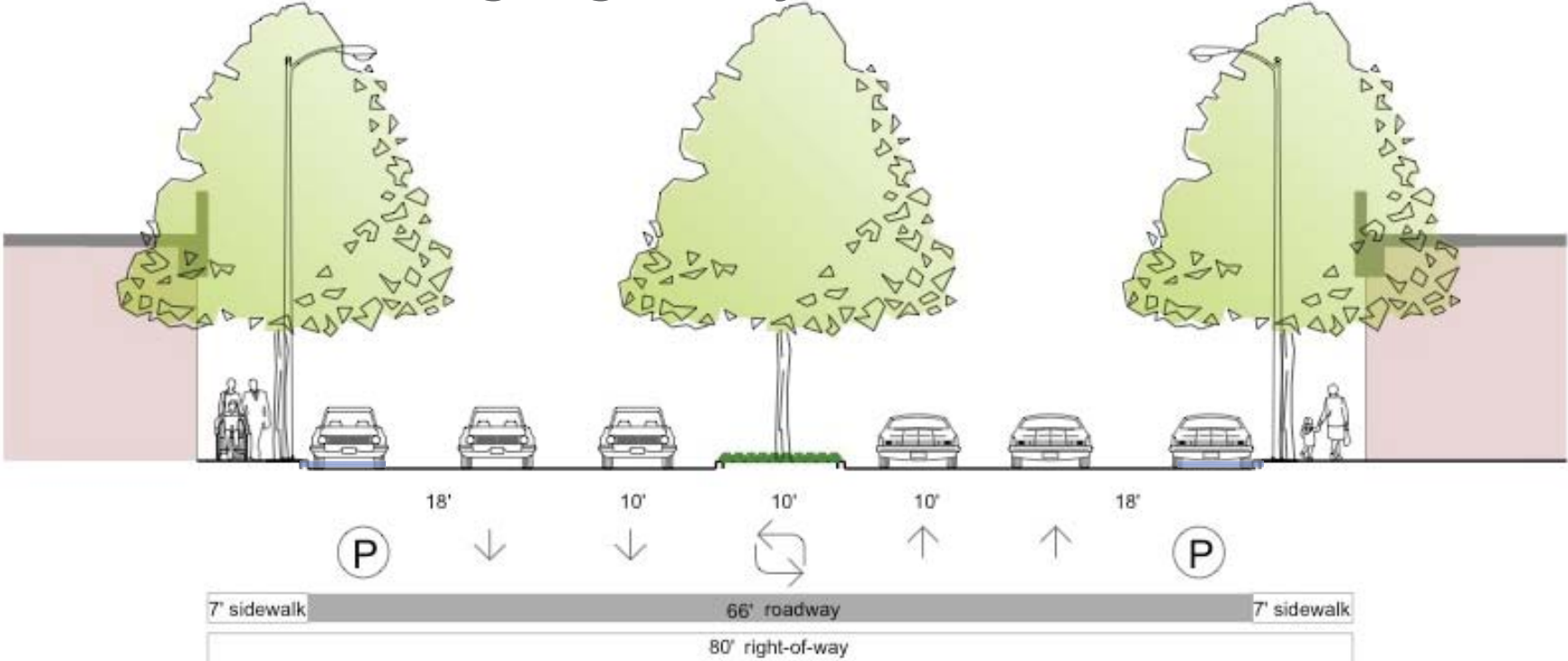

Selected: 40' roadway; 15' sidewalks; -15 pkg. spaces

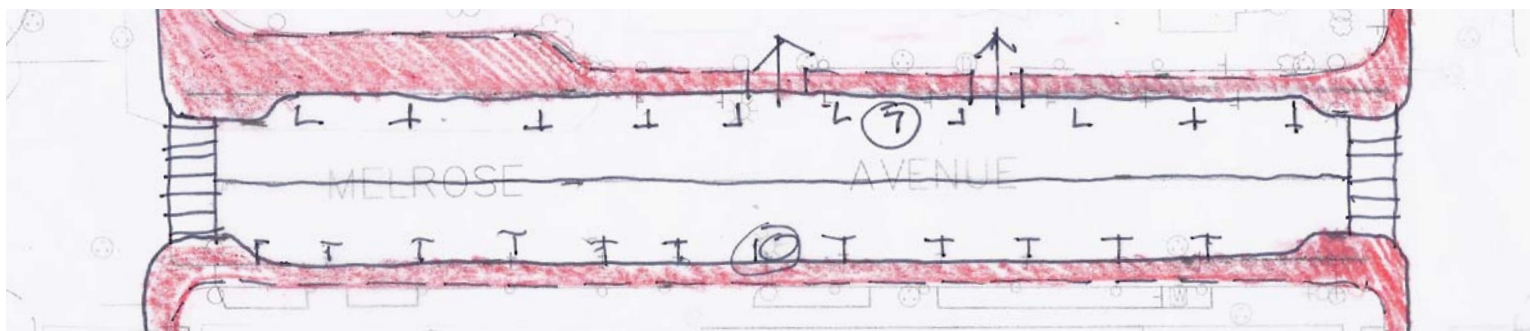
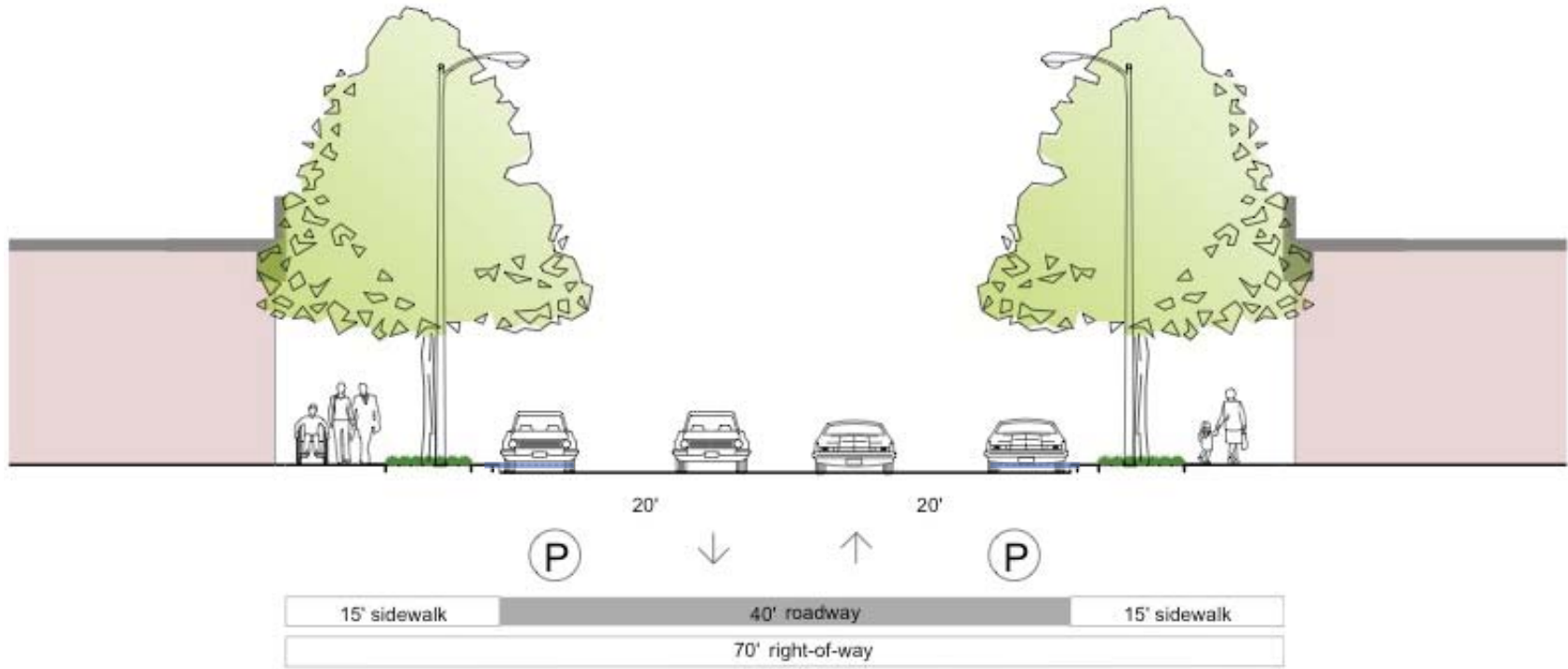

**Melrose west of La Cienega/
Robertson south of Melrose**

Selected: 30' roadway, 15' sidewalks; -25 pkg. spaces

Alternative: selective curb extensions

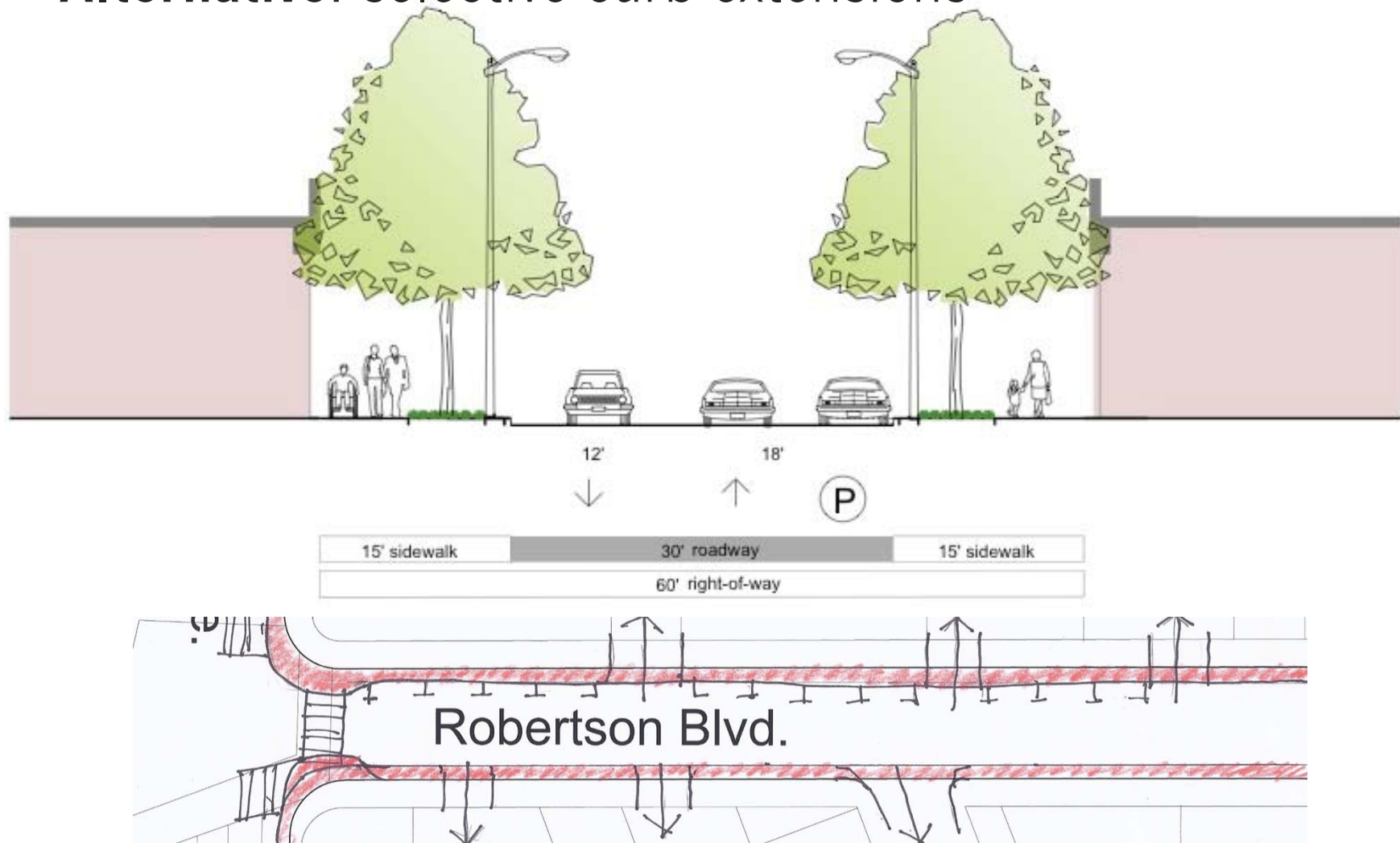

Selected if no Bike Lanes: Existing + landscaped center medians where possible

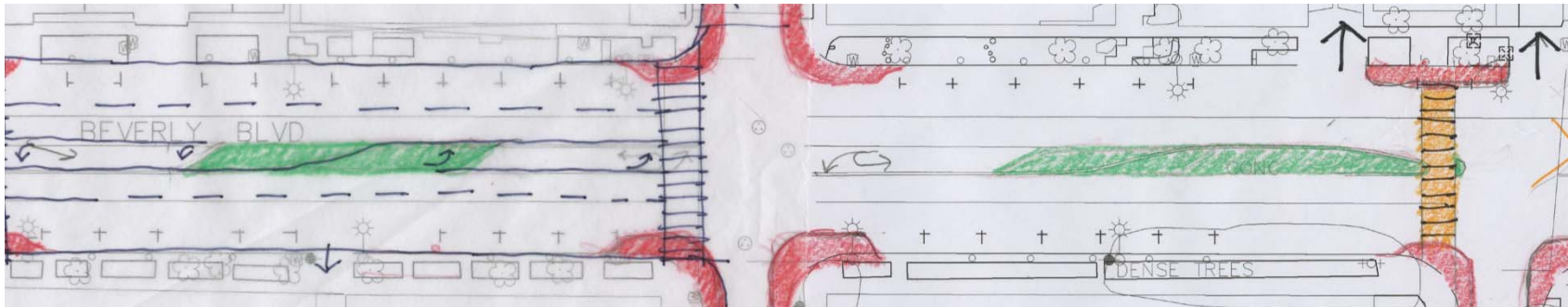
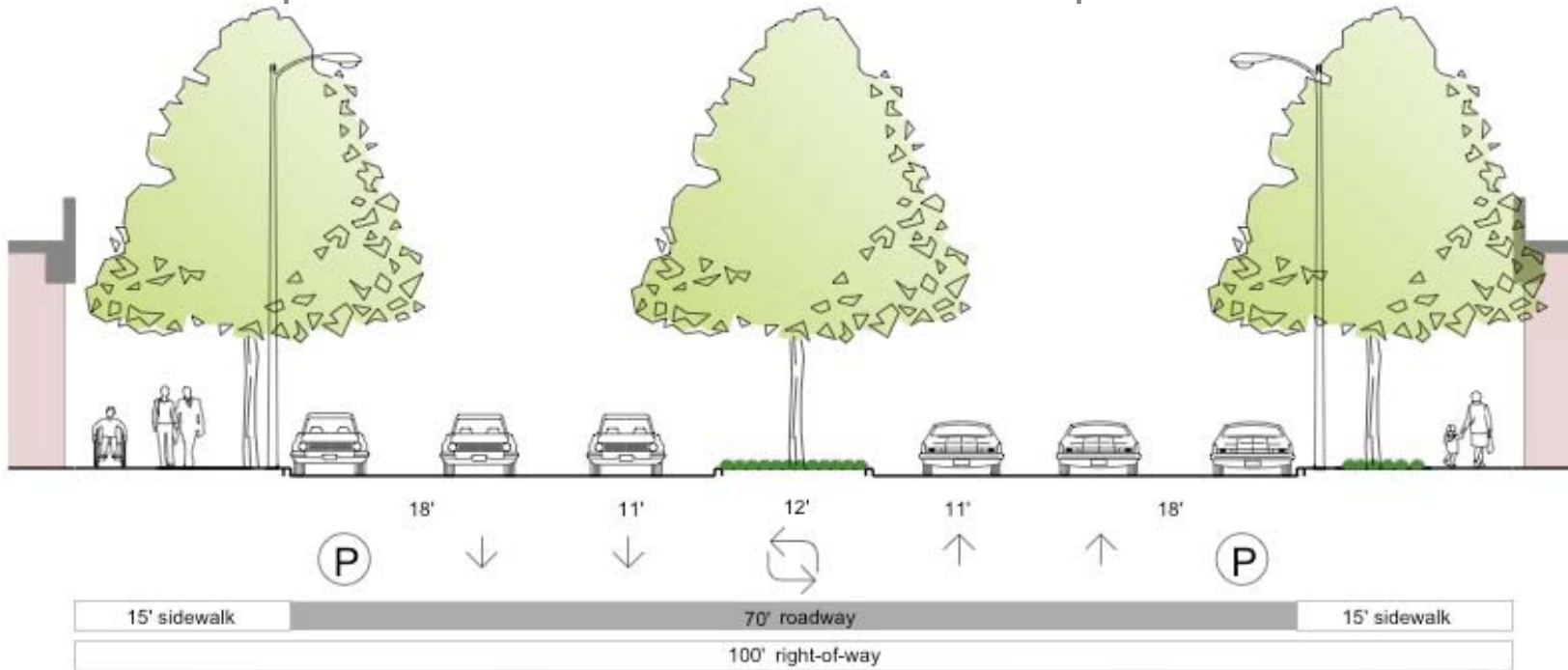

Best Practices To Implement Everywhere Appropriate

1. Corner curb extensions
2. Bus stop curb extensions
3. Directional corner ramps
4. Crosswalks at every intersection
5. Crosswalk median refuges
6. Crosswalks staggered through medians
7. Raised, textured crosswalks
8. Unsignalized crosswalk hawkeye flashers
9. Bike sharrow markings if no bike lanes
10. Bike sharing program
11. Bike parking
12. Eliminate or narrow curb cuts/driveways
13. Landscaped medians, esp. at gateways
14. Neighborhood neck-downs with landscaping

1. Sidewalk layout
2. Street trees
3. Street lights
4. Crosswalk paving
5. Sidewalk paving
6. Best practices: curb extension design, landscape, stormwater.

Streetscape Elements to Address Today

Maintenance

	General Fund	Assessment District	BID	Individual Property Owners
Parkways / Tree Wells				
Grates	<input type="checkbox"/>			
Planted		<input type="checkbox"/>	<input type="checkbox"/>	<input type="checkbox"/>
Stabilized DG		<input type="checkbox"/>	<input type="checkbox"/>	<input type="checkbox"/>
Grates				
Mulch; to be planted by property or business owners		<input type="checkbox"/>	<input type="checkbox"/>	<input type="checkbox"/>
Street Trees				
Canopy trees	<input type="checkbox"/>			
Street Lights				
Roadway lights (30')	<input type="checkbox"/>			
All mid-height (20')	<input type="checkbox"/>			
Pedestrian lights (12') - only in combination with roadway lights		<input type="checkbox"/>		
String lights		<input type="checkbox"/>		
Curb Extensions				
Paved	<input type="checkbox"/>			
Planted		<input type="checkbox"/>		

Maintenance

	General Fund	Assessment District	BID	Individual Property Owners
Sidewalk Paving				
Concrete	<input type="checkbox"/>			
Higher-quality paving throughout		<input type="checkbox"/>		
Higher-quality paving upgrade by owner				<input type="checkbox"/>
Higher-quality paving at key locations, e.g., curb extensions		<input type="checkbox"/>		
Crosswalk Paving - Signalized Intersections				
Signalized intersections:				
Zebra stripes	<input type="checkbox"/>			
Colored concrete pattern		<input type="checkbox"/>		
Lithocrete		<input type="checkbox"/>		
Pavers		<input type="checkbox"/>		
Crosswalk Paving - Unsignalized Intersections				
Zebra stripes only	<input type="checkbox"/>			

Melrose / Robertson – widening sidewalk by 5'

- Parkways or tree wells
- Include existing tree locations or locate along curb
- Planted, mulch, stabilized DG, or metal grates

Beverly – no change in (E) sidewalk width

- Parkways
- Existing locations
- Planted

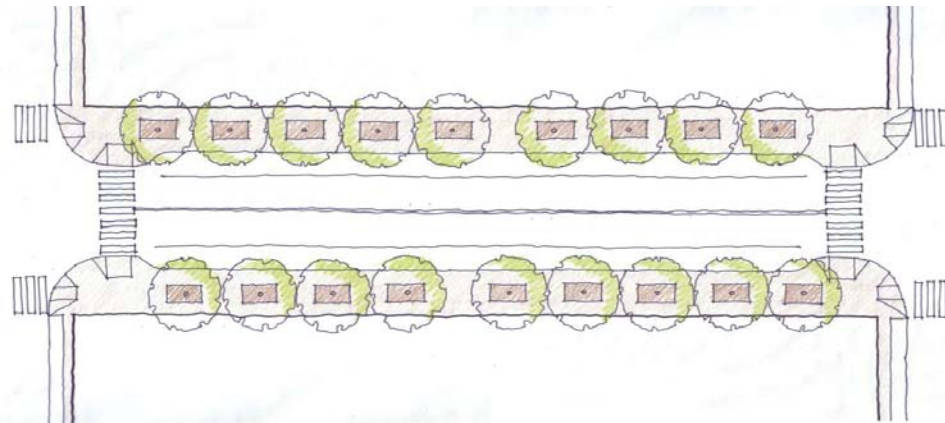

1. Tree wells in (E) tree locations

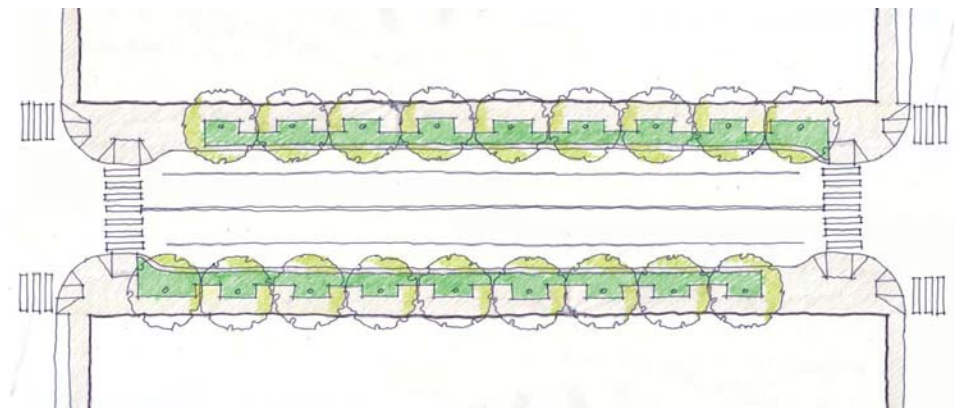

3. Parkways including (E) tree locations

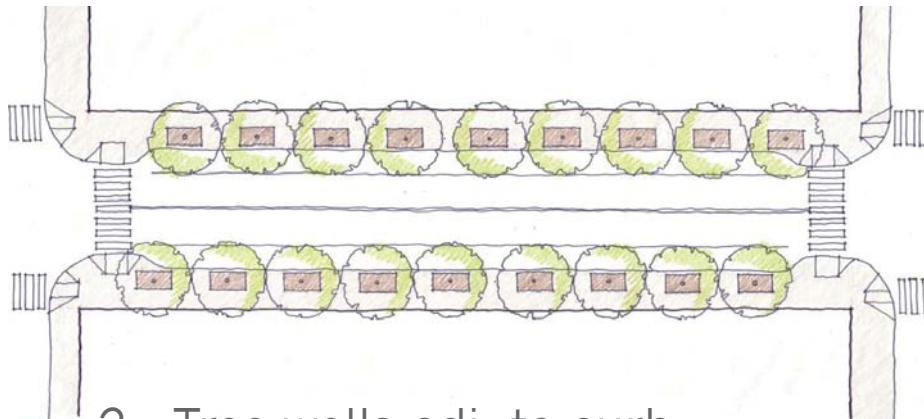

2. Tree wells adj. to curb

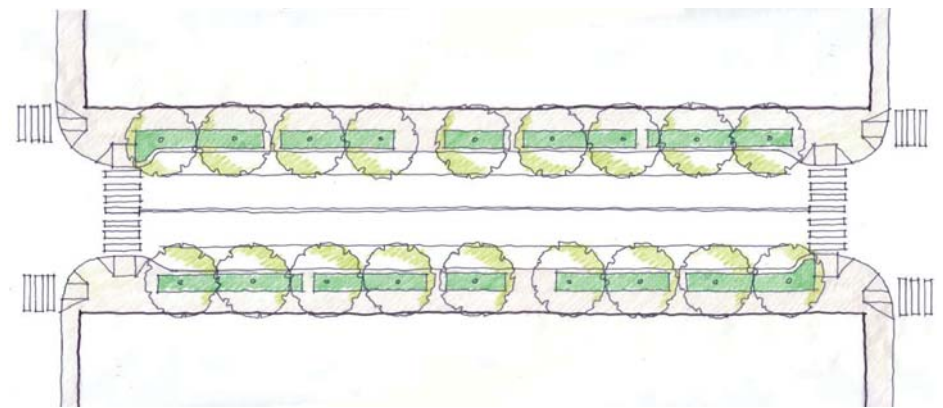

4. Narrower parkways adj. to curb

Sidewalk Layout Options – Melrose & Robertson

1. Tree wells in (E) tree locations

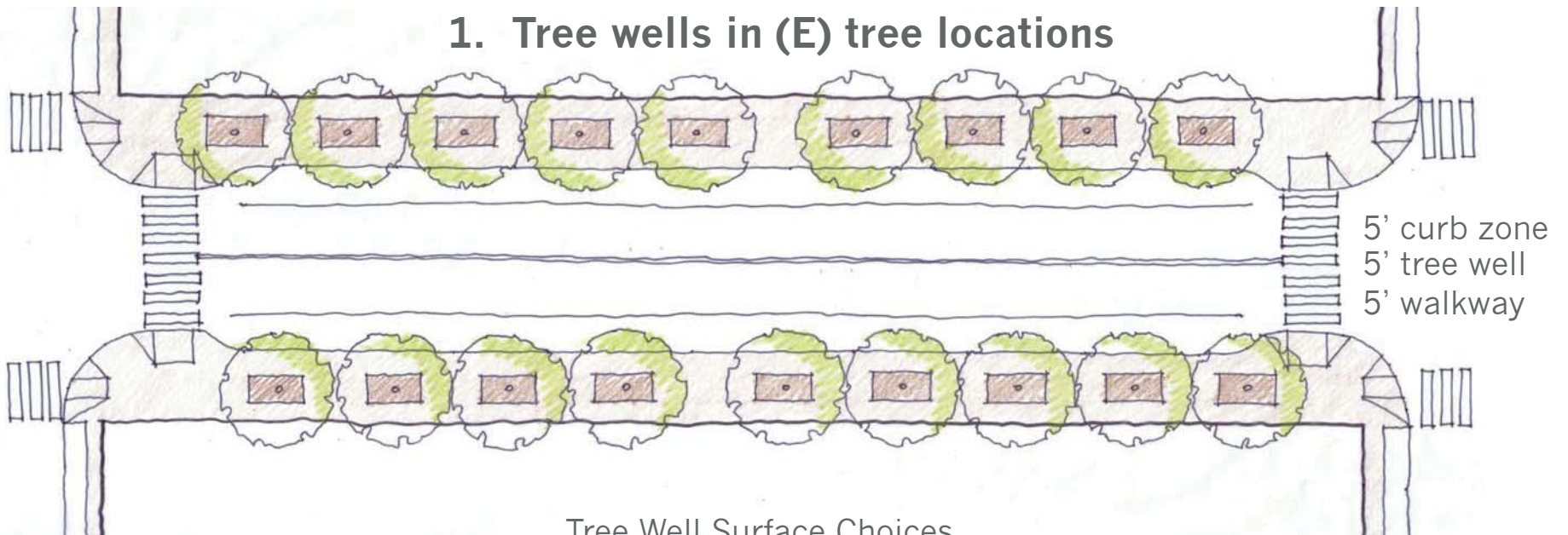

Tree Well Surface Choices



Tree grates



Stabilized DG



Planted



Mulch - Planting by Owner

Sidewalk Layout Options – Melrose & Robertson

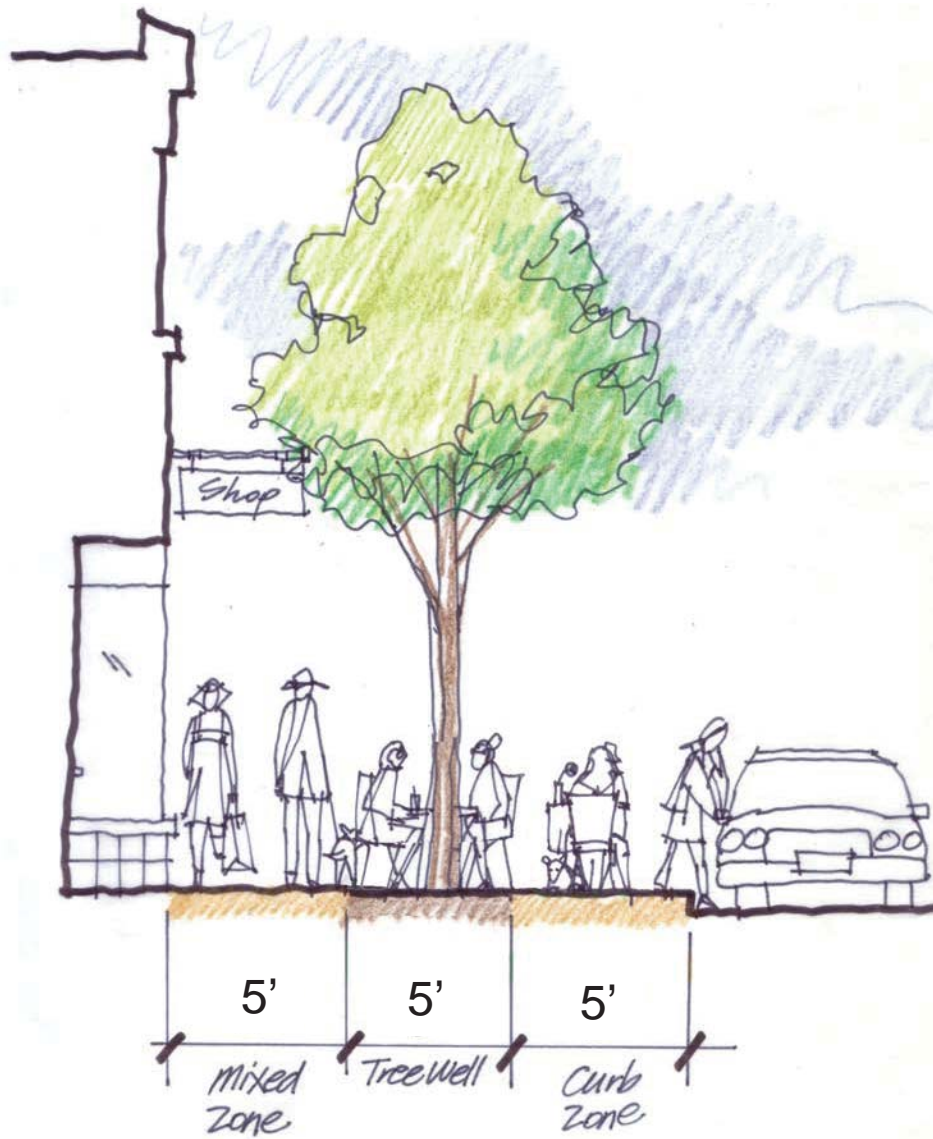

1. Tree wells in (E) tree locations



Sidewalk Layout Options – Melrose & Robertson

2. Tree wells adj. to curb

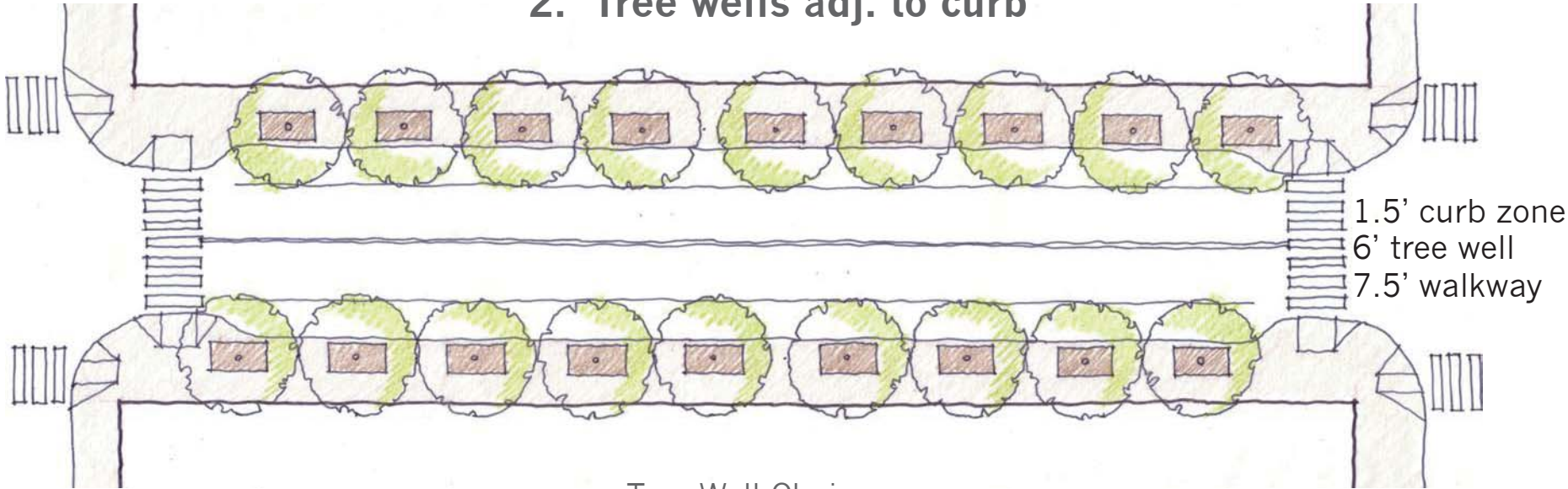

Tree Well Choices



Grates



Stabilized DG



Planted



Mulch - Planting by Owner

Sidewalk Layout Options – Melrose & Robertson

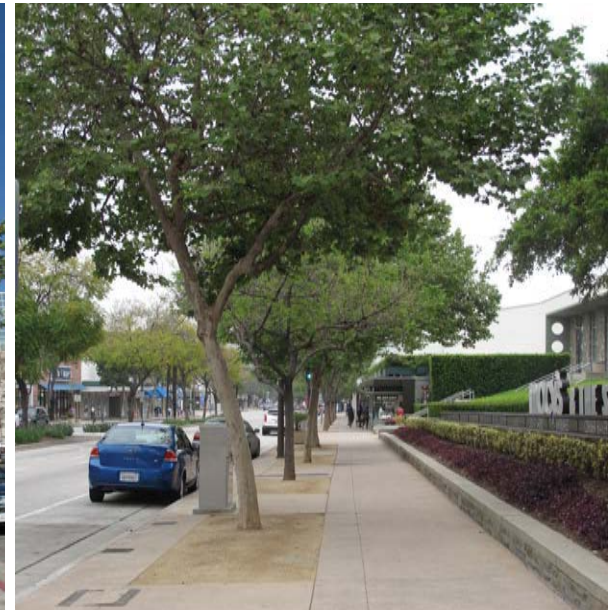
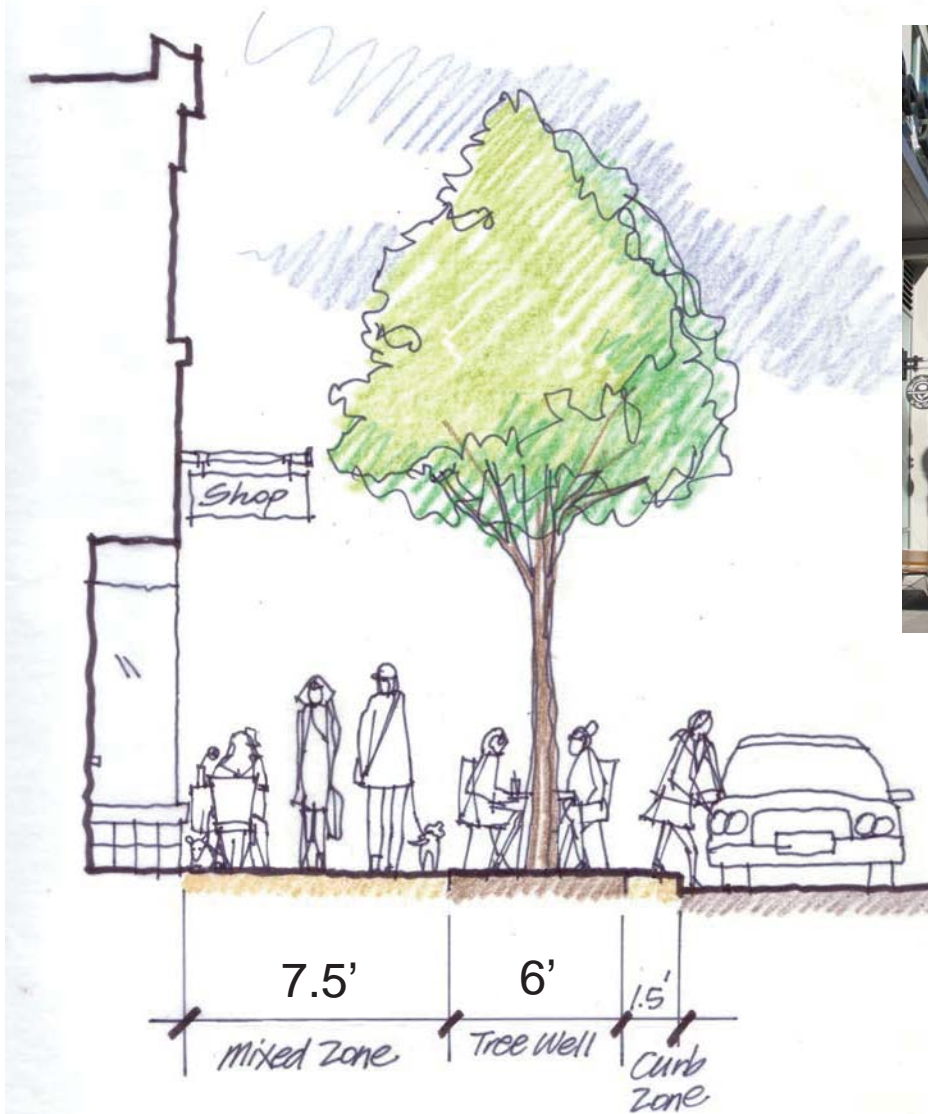

2. Tree wells adj. to curb

Sidewalk Layout Options – Melrose & Robertson

3. Parkways that include (E) tree locations & dining, seating, etc.

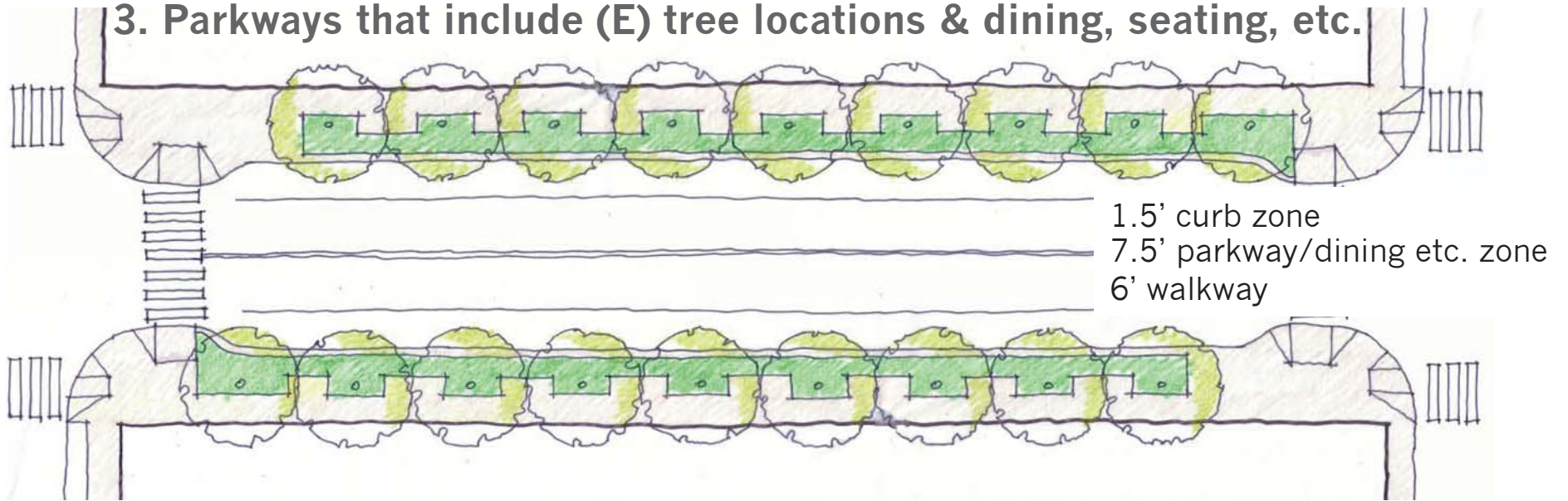

Parkways – Planted & Dining Examples



Sidewalk Layout Options – Melrose & Robertson

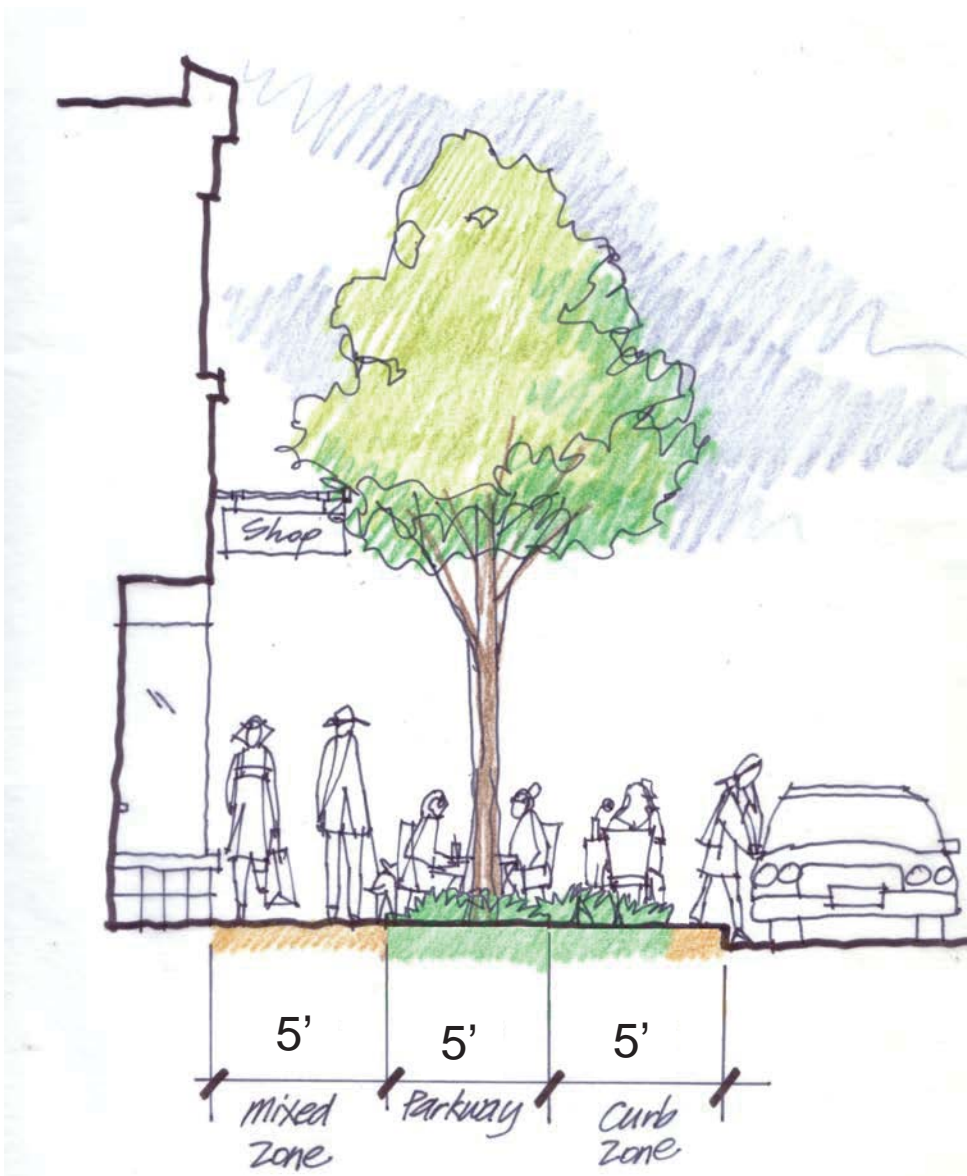

3. Parkway including (E) tree locations

Sidewalk Layout Options – Melrose & Robertson

Parkways that include (E) tree locations – layout options

Path from parked cars

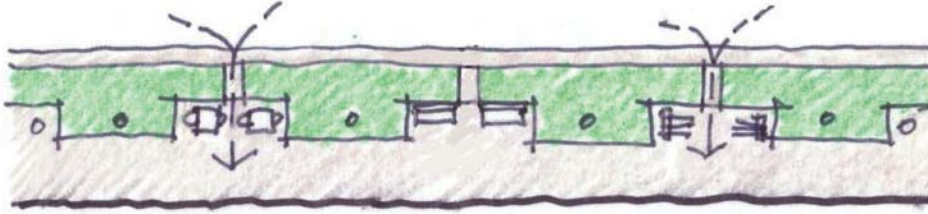

Entirely planted with alcoves

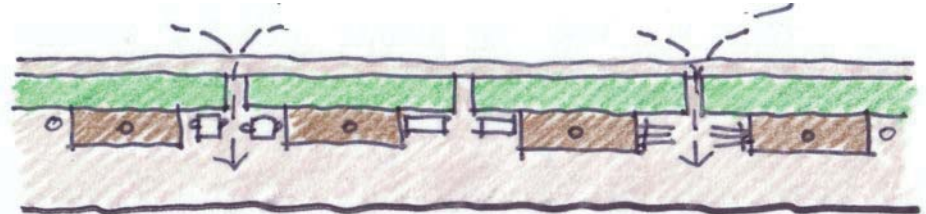

Planted edge with alcoves

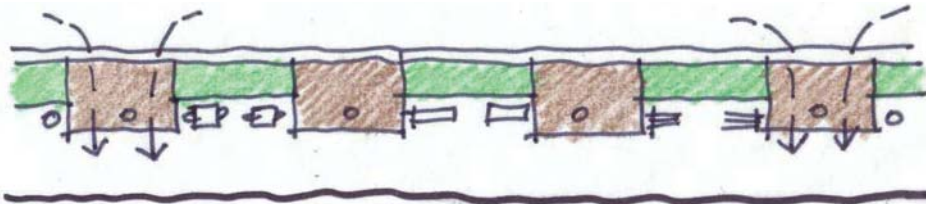

Half-planted edge with alcoves

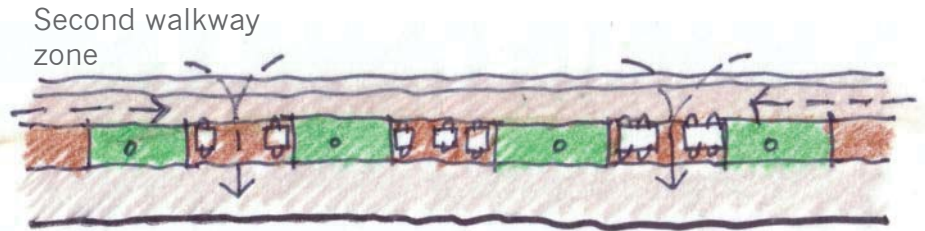

Strip planting/amenity zone

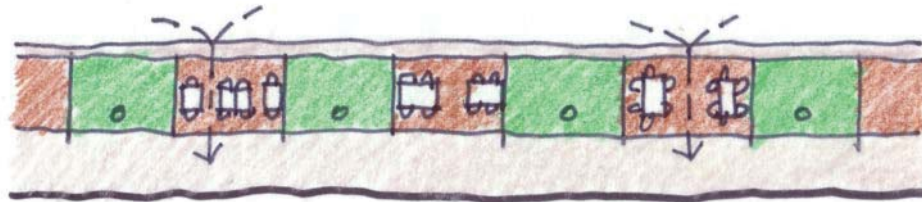

Large outdoor rooms for dining/amenities

Sidewalk Layout Options

4. Narrower parkways along the curb

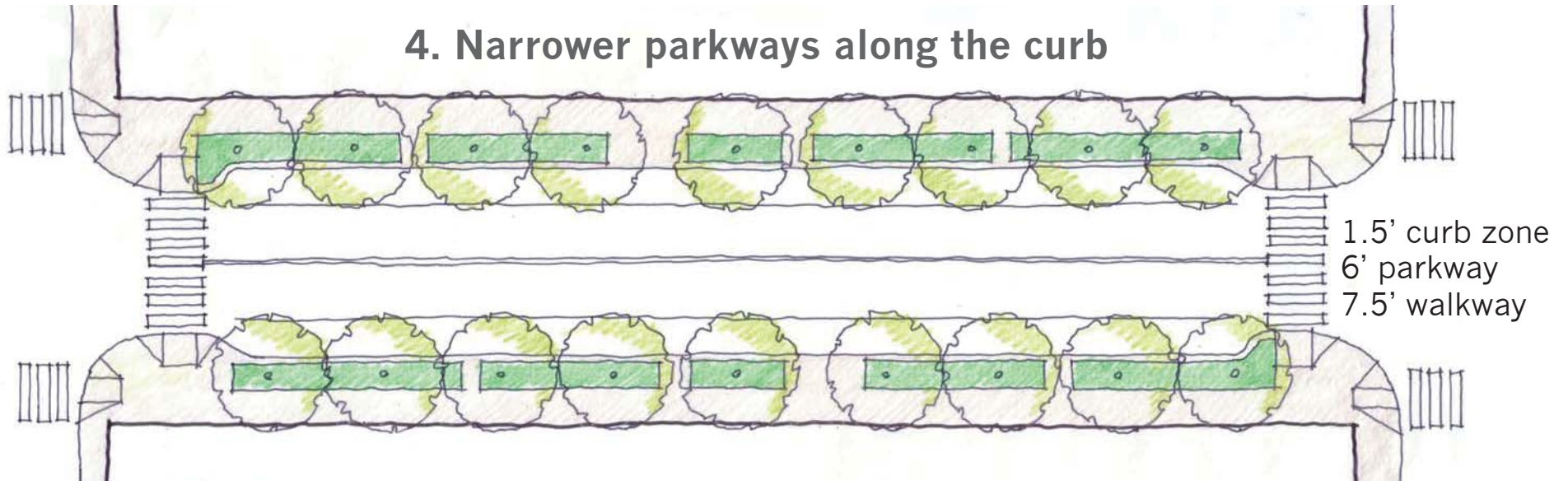

Parkway Examples

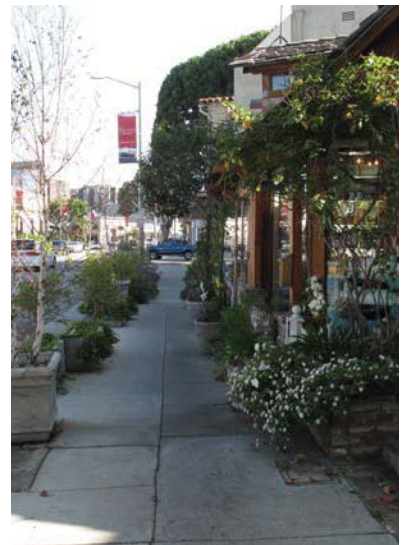
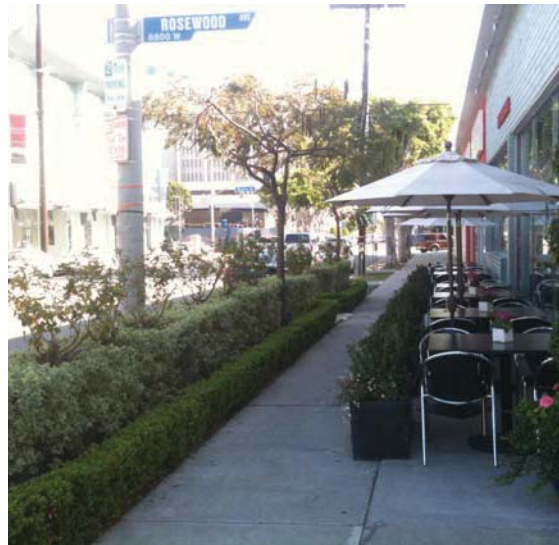

Sidewalk Layout Options – Melrose & Robertson

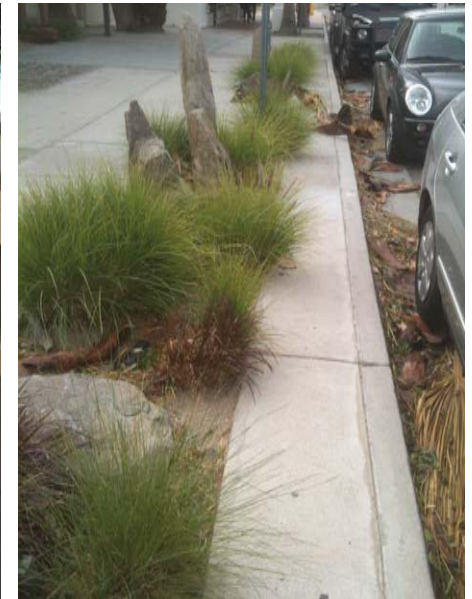
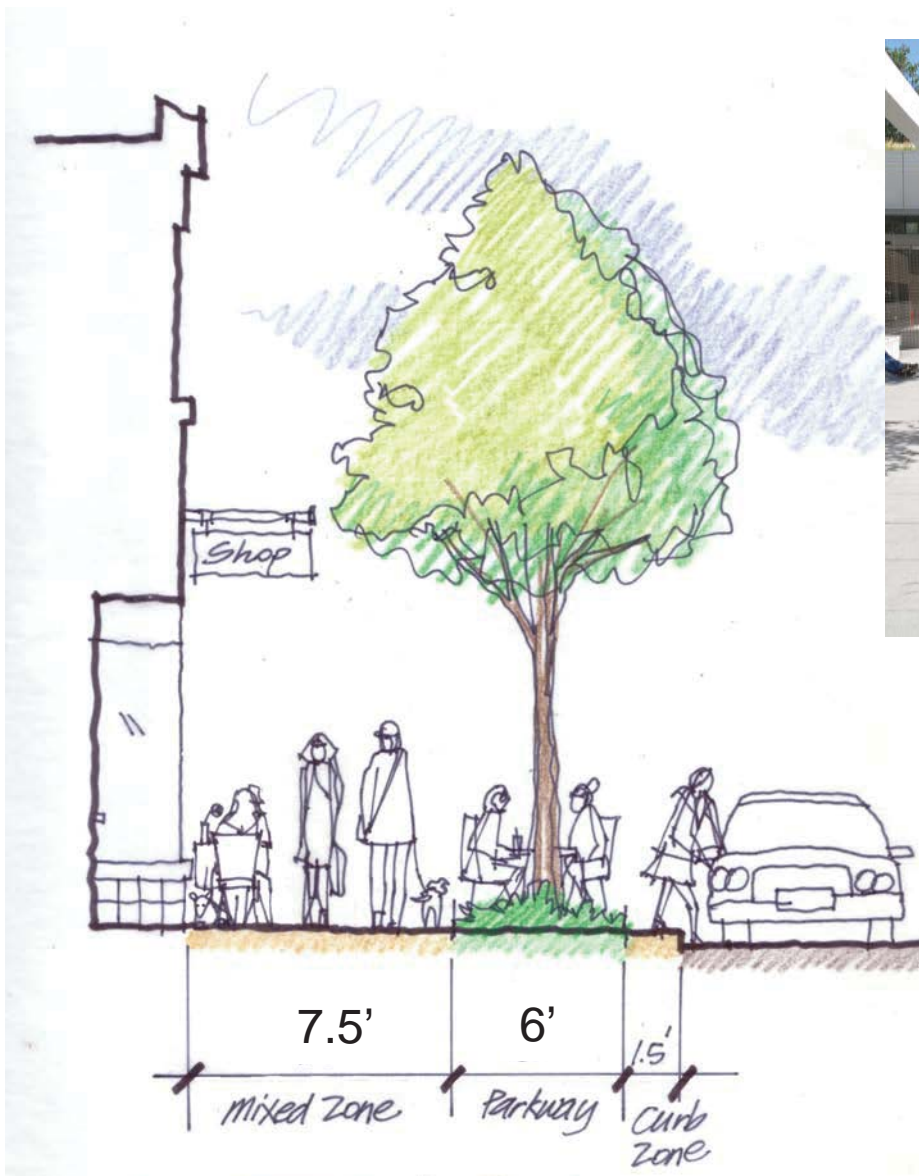

4. Narrower parkways adj. to curb

Sidewalk Layout Options – Melrose & Robertson



More Examples

Basic Criteria

1. Compatible with storefronts
2. In scale with street:
 - Melrose/Robertson
30-40' tall x 25-30' wide
 - Beverly
40-50' tall x 30' wide
3. Unique to Avenues/diversity
4. Adequate soil volume
5. Adequate water



Street Trees



4x4 tree wells
little irrigation



4x6 tree wells + structural
soil and irrigation



Parkways or bigger tree wells
some irrigation

Street Trees – Basic Criteria

Melrose / Robertson

Mix of tree types:

1. Existing
2. Mix of existing and new
3. Mix of all new:
 - By segment
 - Alternating

Form:

1. Columnar
2. Vase/oval
3. Both

Leaves:

1. Deciduous
2. Evergreen
3. Both

Color:

1. Flowering
2. Fall
3. Both
4. Neither

Mix



By Block or Segment

Street Tree Options

Mix



Alternating

Street Tree Options

Form



spreading



pyramidal



columnar



weeping



oval

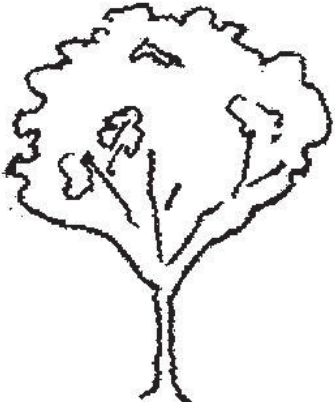

vase

Sweetshade (E)
evergreen, flowers, columnar



Gold Medallion (E)
evergreen, flowers, vase



Street Trees – Melrose/Robertson

Hong Kong Orchid
briefly deciduous, flowers, vase



Australian Willow
evergreen, vase

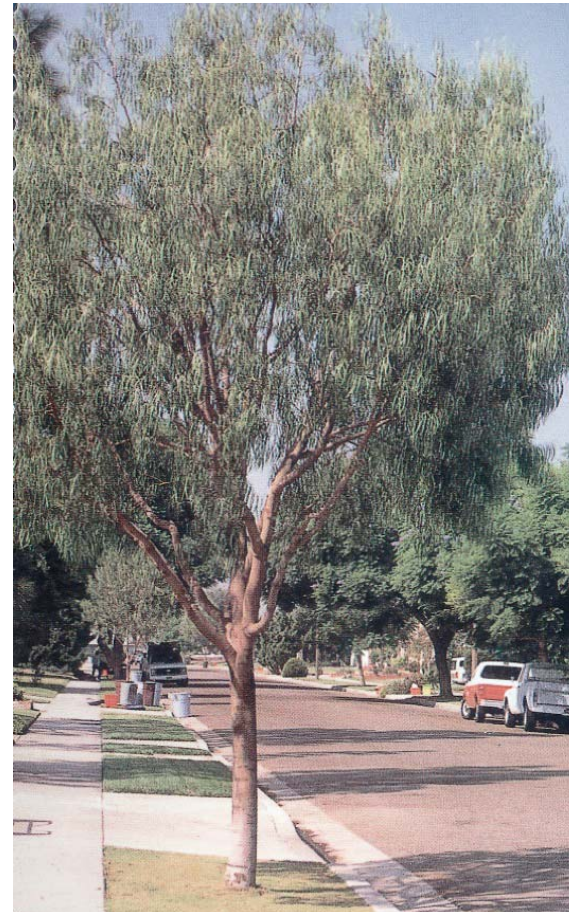

Street Trees – Melrose/Robertson

Pink Trumpet

briefly deciduous, flowers, vase

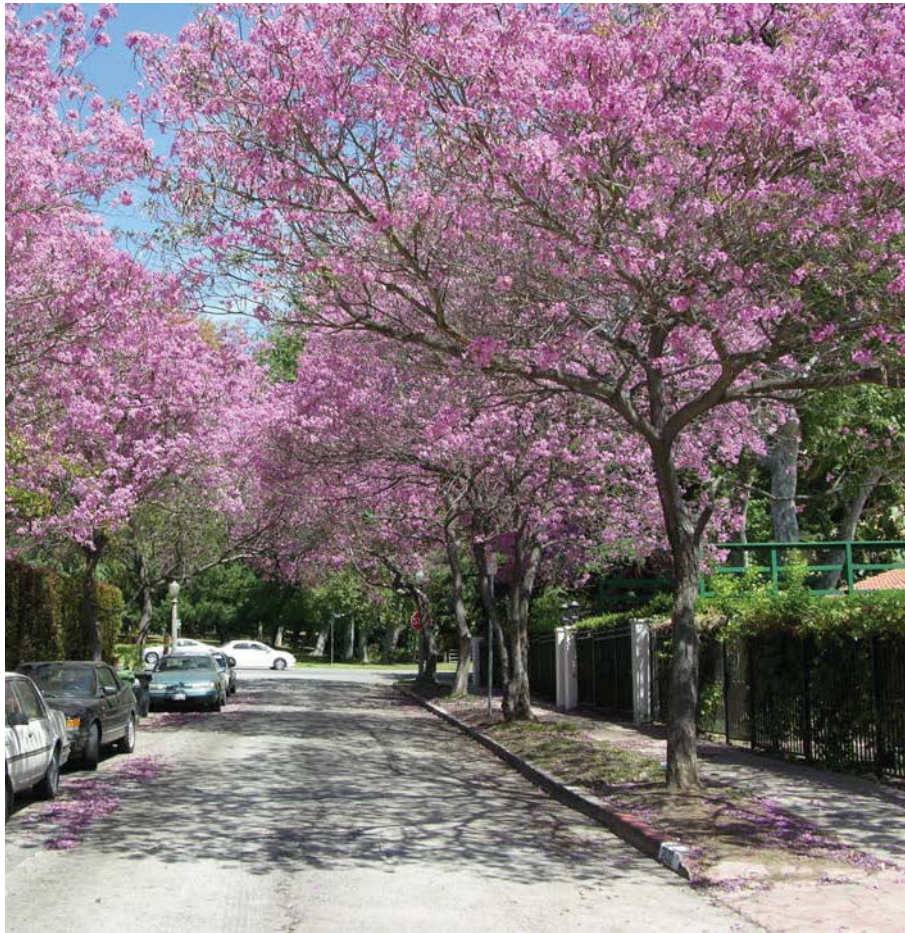

Chinese Flame

briefly deciduous, flowers, vase



Street Trees – Melrose/Robertson

London Plane

deciduous, oval



Street Trees – Melrose/Robertson

Evergreen Pear
evergreen, flowers, vase



African Tulip
evergreen, flowers, vase



Street Trees – Melrose/Robertson

Liquidambar (E)

deciduous, fall color, columnar



Southern Magnolia (E)

evergreen, flowers, oval



Street Trees – Beverly

Australian Flame
evergreen, columnar



Ginkgo
deciduous, fall color, oval

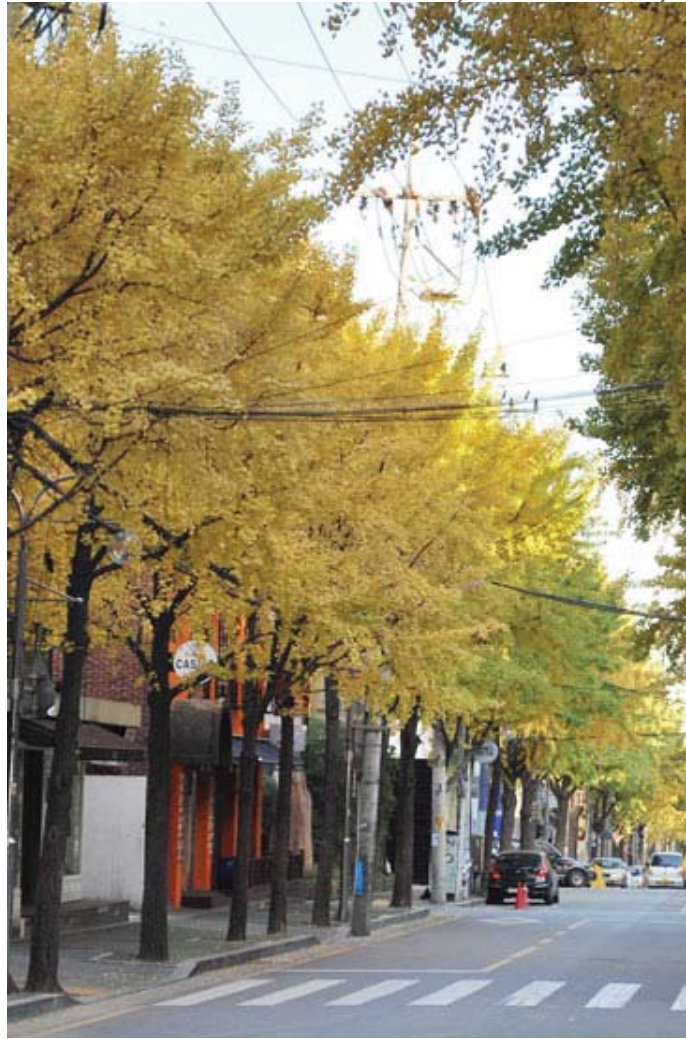

Street Trees – Beverly

London Plane

deciduous, oval



Mexican Sycamore

very briefly deciduous, columnar

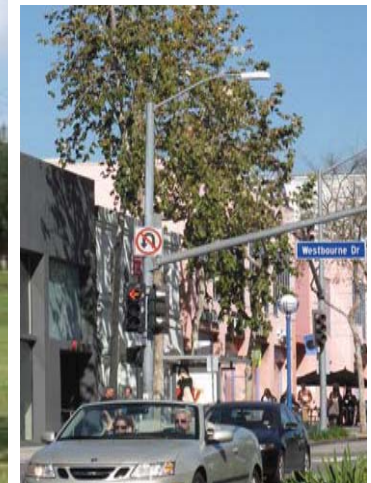
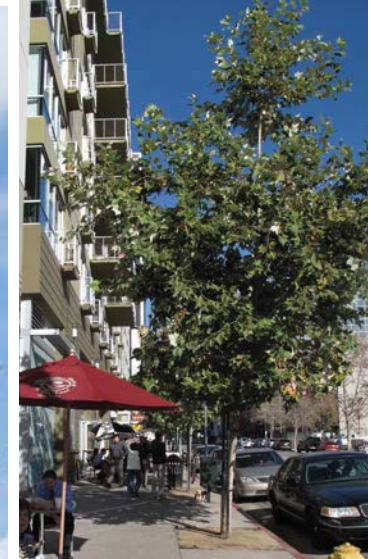

Street Trees – Beverly

Three basic approaches:

- 1. Keep roadway lights as sole source of illumination**
Can replace cobra heads & arms with updated versions (LED)
- 2. Keep roadway lights and add supplemental lights**
Pedestrian poles, string lights, pole lights
- 3. Replace roadway lights with a mid-height fixture**
between the height of a roadway and pedestrian light

Factors to be considered:

- Any option can be designed to meet **IESNA standards**.
- **Banners can still be accommodated:** 8' long on 30' roadway pole, 5-6' long on 20' mid-height pole.
- **Luminaire technology and fixture styles change quickly;** best to identify “design characteristics” and choose exact fixture when streetscape improvements are funded & being designed
- Advantage of lines that offers a “**family of elements.**”
- The City will maintain all roadway and mid-height lights, but an **assessment district will need to pay for the ongoing maintenance of pedestrian, low-level or string lights.**

Lighting Type Options

1. Roadway (30') only

2. Roadway (30') + Ped. (12')

3. Roadway (30') + Low Level

4. Roadway (30') + String Lights
Either parallel to curb or across roadway

5. Mid-height (20') only
Except on Beverly due to street width

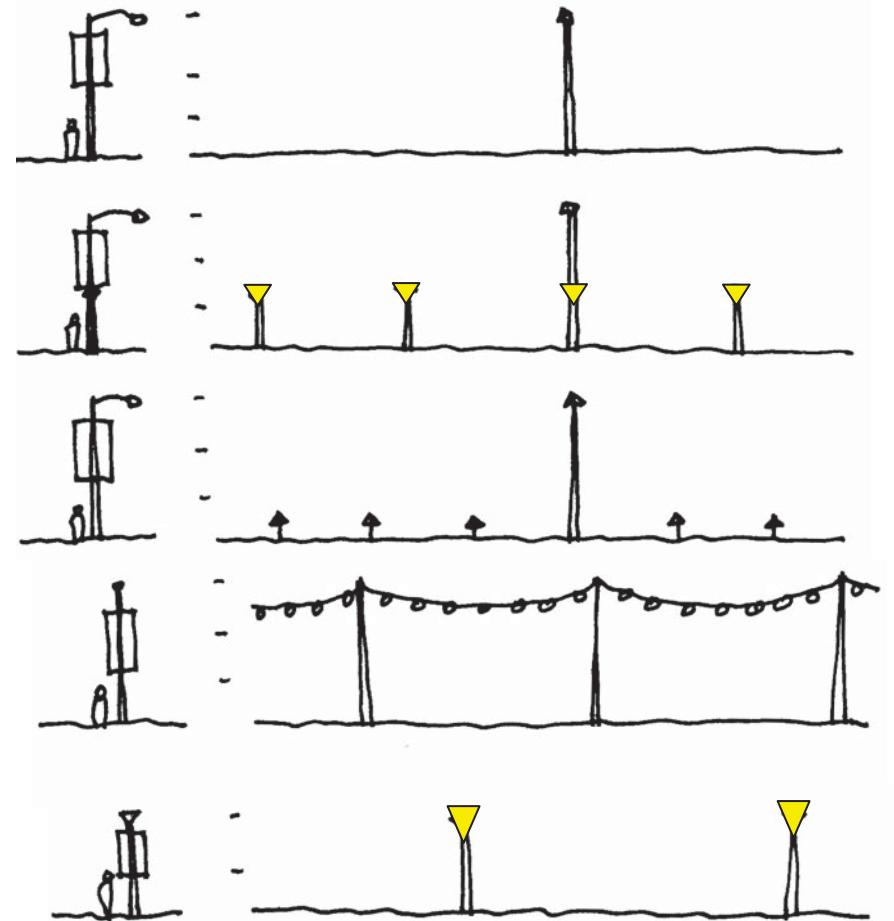

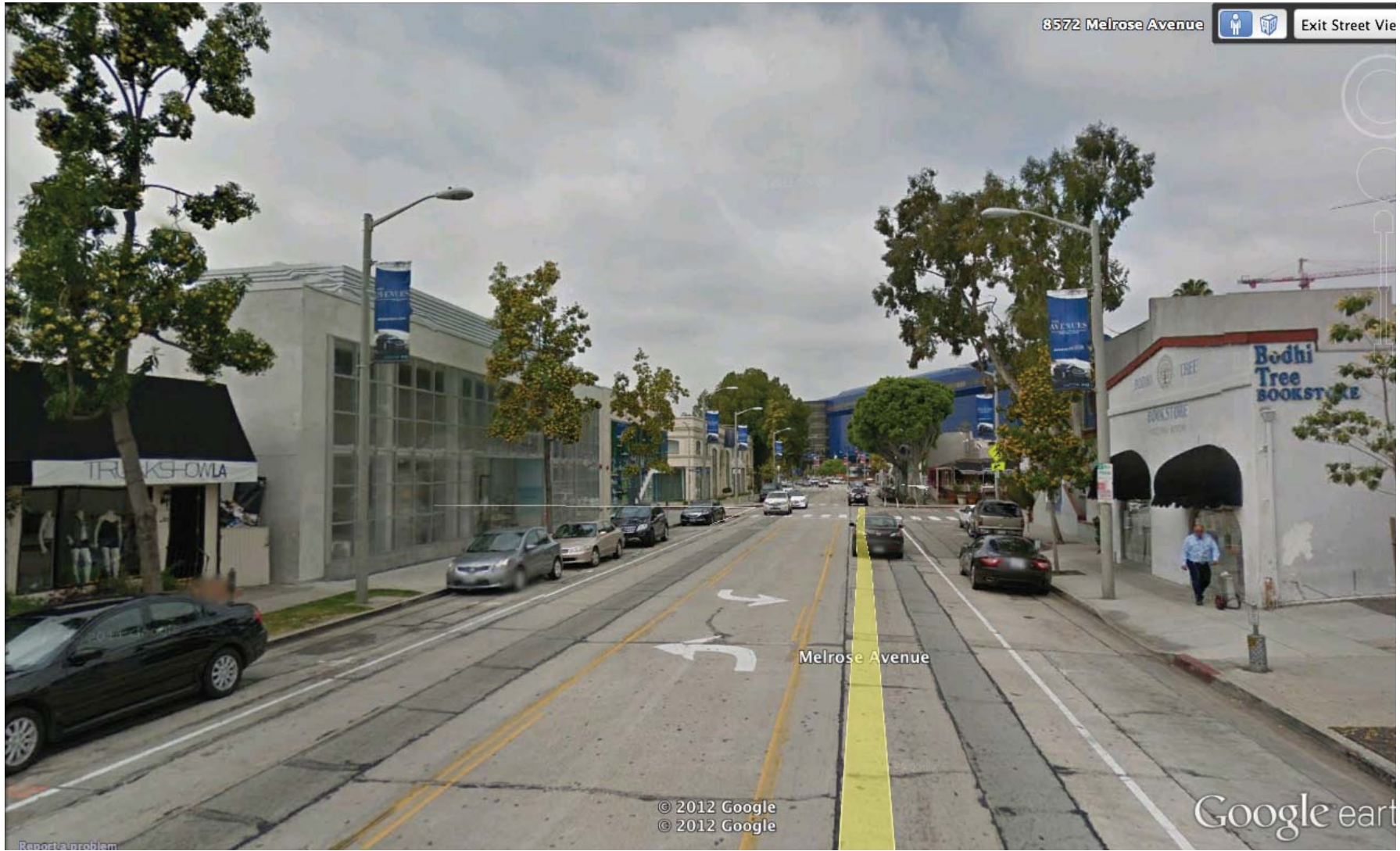

Melrose - Existing